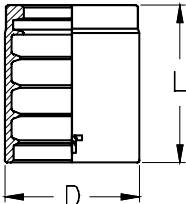
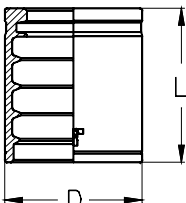
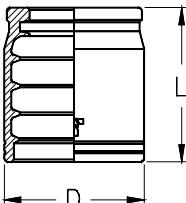

NO SKIVE	HSC	SWAGED NON SKIVE FERRULE BOCCOLA A PRESSARE NON SKIVE										
		TIEFFE Part. N°	Hose I.D. Ø Interno tubo			Dimensions (mm)		Applications Applicazioni				
			DN	SIZE	Inch	D	L					
	HSC04	6	04	1/4"	19	23	1SC					
	HSC05	8	05	5/16"	20	27,5	1SC					
	HSC06	10	06	3/8"	23	30	1SC					
	HSC08	12	08	1/2"	26,5	32	1SC					
	HSC10	16	10	5/8"	29	35	1SC					
	HSC12	19	12	3/4"	33	34	1SC					
	HSC16	25	16	1"	42	45	1SC					

NO SKIVE	HXT1	SWAGED NON SKIVE FERRULE BOCCOLA A PRESSARE NON SKIVE										
		TIEFFE Part. N°	Hose I.D. Ø Interno tubo			Dimensions (mm)		Applications Applicazioni				
			DN	SIZE	Inch	D	L					
	HXT103	5	03	3/16"	19	24	1SN	R1AT				
	HXT104	6	04	1/4"	20	27	1SN	R1AT	2SC			
	HXT105	8	05	5/16"	22	27,5	1SN	R1AT	2SC			
	HXT106	10	06	3/8"	24,5	30	1SN	R1AT	2SC			
	HXT108	12	08	1/2"	28	32,5	1SN	R1AT	2SC			
	HXT110	16	10	5/8"	32	35	1SN	R1AT	2SC			
	HXT112	19	12	3/4"	36	40	1SN	R1AT	2SC			
	HXT116	25	16	1"	45	50	1SN	R1AT	2SC			
	HXT120	31	20	1 1/4"	54	50	1SN	R1AT				
	HXT124	38	24	1 1/2"	62	55	1SN	R1AT				
	HXT132	51	32	2"	76	60	1SN	R1AT				

NO SKIVE	HXT	SWAGED NON SKIVE FERRULE BOCCOLA A PRESSARE NON SKIVE										
		TIEFFE Part. N°	Hose I.D. Ø Interno tubo			Dimensions (mm)		Applications Applicazioni				
			DN	SIZE	Inch	D	L					
	HXT03	5	03	3/16"	20	24	2SN	R2AT				
	HXT04	6	04	1/4"	22	26	2SN	R2AT	1SN	R1AT	2SC	
	HXT05	8	05	5/16"	24	27,5	2SN	R2AT	1SN	R1AT	2SC	
	HXT06	10	06	3/8"	26	30	2SN	R2AT	1SN	R1AT	2SC	
	HXT08	12	08	1/2"	30	32,5	2SN	R2AT	1SN	R1AT	2SC	
	HXT10	16	10	5/8"	34	35	2SN	R2AT	1SN	R1AT	2SC	
	HXT12	19	12	3/4"	38	40	2SN	R2AT	1SN	R1AT	2SC	
	HXT16	25	16	1"	48	50	2SN	R2AT				
	HXT20	31	20	1 1/4"	60	57	2SN	R2AT				
	HXT24	38	24	1 1/2"	67	62	2SN	R2AT				
	HXT32	51	32	2"	80	66	2SN	R2AT				

For SAE100 R16 - SAE100 R17 and other compact braided hoses applications, contact TIEFFE.

Voor toepassing van SAE100 R16-SAE100 R17slang neem contact op met FLEXTUBO

		B.S.P. BANJO BANJOKOPPELING BSP									
TIEFFE Part.N.	Hose I.D. Ø interno tubo			Thread Filettatura	Dimensions (mm)						
	DN	Size	Inch	F	H	L	D	S			
XQB0203	5	03	3/16"	1/8"-28	20	45	10,2	10			
XQB0403	5	03	3/16"	1/4"-19	22,6	47,6	13,3	14			
XQB0204	6	04	1/4"	1/8"-28	23	51	10,2	10			
XQB0404	6	04	1/4"	1/4"-19	23	51	13,3	14			
XQB0604	6	04	1/4"	3/8"-19	26,5	54,5	16,8	17,5			
XQB0804	6	04	1/4"	1/2"-14	33,5	61,5	21	23			
XQB0405	8	05	5/16"	1/4"-19	24	52	13,3	14			
XQB0605	8	05	5/16"	3/8"-19	26,5	54,5	16,8	17,5			
XQB0805	8	05	5/16"	1/2"-14	33,5	61,5	21	23			
XQB0406	10	06	3/8"	1/4"-19	24	54,5	13,3	14			
XQB0606	10	06	3/8"	3/8"-19	24	54,5	16,8	17,5			
XQB0806	10	06	3/8"	1/2"-14	32	62,5	21	23			
XQB0608	12	08	1/2"	3/8"-19	26,5	59,5	16,8	17,5			
XQB0808	12	08	1/2"	1/2"-14	28,5	61,5	21	23			
XQB1008	12	08	1/2"	5/8"-14	31	64	23,1	23,5			
XQB1208	12	08	1/2"	3/4"-14	39	72	26,5	29,5			
XQB0810	16	10	5/8"	1/2"-14	27,2	63	21	23			
XQB1010	16	10	5/8"	5/8"-14	28,2	64	23,1	23,5			
XQB1210	16	10	5/8"	3/4"-14	34,7	70,5	26,5	29,5			
XQB1212	20	12	3/4"	3/4"-14	37,5	78	26,5	29,5			
XQB1612	20	12	3/4"	1"-11	39,5	90,5	33,5	37,5			
XQB1616	25	10	1	1"-11	49	100	33,5	37,5			

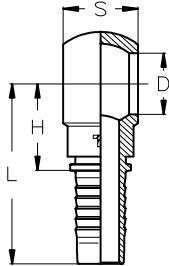

		B.S.P. BANJO BOLT BANJOBOUT BSP						
TIEFFE Part.N.			Thread Filettatura	Dimensions (mm)				
			F	L	L1	S		
QMB02			1/8"-28	26	21,5	14		
QMB04			1/4"-19	34,3	29,5	19		
QMB06			3/8"-19	40,5	34	22		
QMB08			1/2"-14	46	36	27		
QMB10			5/8"-14	55	45,5	30		
QMB12			3/4"-14	56	48	32		
QMB16			1"-11	69	59	41		

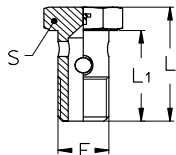

AGJ	J.I.C. MALE - 74° CONE SLANGKOPPELING BU.DR. J.I.C. - CONUS 74°											
	TIEFFE Part. N.	Hose I.D. Ø interno tubo			Thread Filetto	Dimensions (mm)						Maximum WP
		DN	Size	Inch	F	H	L	S				bar
XJM0703	5	03	3/16"	7/16"-20	26,3	52	12				415	
XJM0803	5	03	3/16"	1/2"-20	26,3	52	14				415	
XJM0704	6	04	1/4"	7/16"-20	26,5	55	12				450	
XJM0804	6	04	1/4"	1/2"-20	26,5	55	14				450	
XJM0904	6	04	1/4"	9/16"-18	26,5	55	15				450	
XJM0805	8	05	5/16"	1/2"-20	26,5	55	14				350	
XJM0905	8	05	5/16"	9/16"-18	26,5	55	15				350	
XJM1205	8	05	5/16"	3/4"-16	30,2	58,7	19				350	
XJM0906	10	06	3/8"	9/16"-18	26,5	57	15				450	
XJM1206	10	06	3/8"	3/4"-16	30,2	60,5	19				415	
XJM1406	10	06	3/8"	7/8"-14	34,2	64,7	24				350	
XJM1208	12	08	1/2"	3/4"-16	31	64	19				415	
XJM1408	12	08	1/2"	7/8"-14	35,5	68	24				350	
XJM1708	12	08	1/2"	1 1/16"-12	38,5	71,5	27				350	
XJM1410	16	10	5/8"	7/8"-14	35	71	24				350	
XJM1710	16	10	5/8"	1 1/16"-12	38,5	74,5	27				350	
XJM1412	20	12	3/4"	7/8"-14	36	77	27				350	
XJM1712	20	12	3/4"	1 1/16"-12	39,5	80,5	27				350	
XJM1912	20	12	3/4"	1 3/16"-12	41,5	82,5	32				280	
XJM2112	20	12	3/4"	1 5/16"-12	42	83	36				280	
XJM1716	25	16	1"	1 1/16"-12	41	96	32				280	
XJM2116	25	16	1"	1 5/16"-12	42,7	97,7	36				280	
XJM2616	25	16	1"	1 5/8"-12	46	101	46				280	
XJM2620	32	20	1 1/4"	1 5/8"-12	46,5	107,5	46				210	
XJM3020	32	20	1 1/4"	1 7/8"-12	51	112	50				140	
XJM3024	40	24	1 1/2"	1 7/8"-12	51,2	121,7	50				140	
XJM4032	50	32	2"	2 1/2"-12	62,2	138,2	65				105	

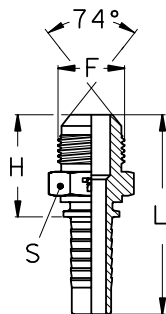

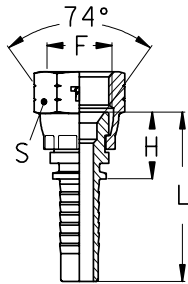

DKJ	J.I.C. FEMALE - 74° CONE SEAT - CRIMPED NUT SLANGKOPPELING WARTEL J.I.C. - CONUS ZITTING 74° - MOER GEPERST											
	TIEFFE Part. N.	Hose I.D. Ø interno tubo			Thread Filetto	Dimensions (mm)						Maximum WP bar
		DN	Size	Inch		F	H	L	S			
XJF0703	5	03	3/16"	7/16"-20		14,5	40,2	15				350
XJF0703SW14	5	03	3/16"	7/16"-20		14,5	40,2	14				350
XJF0803	5	03	3/16"	1/2"-20		16,8	42,5	17				350
XJF0704	6	04	1/4"	7/16"-20		14,7	43,2	15				350
XJF0704SW14	6	04	1/4"	7/16"-20		14,7	43,2	14				350
XJF0804	6	04	1/4"	1/2"-20		16	44,5	17				350
XJF0904	6	04	1/4"	9/16"-18		18	46,5	19				250
XJF0805	8	05	5/16"	1/2"-20		16	44,5	17				350
XJF0905	8	05	5/16"	9/16"-18		17	45,5	19				250
XJF1205	8	05	5/16"	3/4"-16		18,5	47	24				250
XJF1205SW22	8	05	5/16"	3/4"-16		18,5	47	22				250
XJF0906	10	06	3/8"	9/16"-18		17	47,5	19				250
XJF1206	10	06	3/8"	3/4"-16		18,5	49	24				250
XJF1206SW22	10	06	3/8"	3/4"-16		18,5	49	22				250
XJF1406	10	06	3/8"	7/8"-14		19,5	50	27				200
XJF1208	12	08	1/2"	3/4"-16		18,5	51,5	24				250
XJF1208SW22	12	08	1/2"	3/4"-16		18,5	51,5	22				250
XJF1408	12	08	1/2"	7/8"-14		19,5	52,5	27				200
XJF1708	12	08	1/2"	1 1/16"-12		22,5	55,5	32				200
XJF1410	16	10	5/8"	7/8"-14		19,5	55,5	27				200
XJF1710	16	10	5/8"	1 1/16"-12		22,5	58,5	32				200
XJF1412	20	12	3/4"	7/8"-14		20,5	61,5	27				200
XJF1712	20	12	3/4"	1 1/16"-12		22	63	32				200
XJF1912	20	12	3/4"	1 3/16"-12		25,2	66,2	36				160
XJF2112	20	12	3/4"	1 5/16"-12		25,7	66,7	41				160
XJF1716	25	16	1"	1 1/16"-12		23,5	78,5	32				200
XJF2116	25	16	1"	1 5/16"-12		26	81	41				160
XJF2616	25	16	1"	1 5/8"-12		28,8	83,8	50				125
XJF2620	32	20	1 1/4"	1 5/8"-12		27,8	88,8	50				125
XJF3020	32	20	1 1/4"	1 7/8"-12		31	92	55				100
XJF3024	40	24	1 1/2"	1 7/8"-12		31,5	102	55				100
XJF4032	50	32	2"	2 1/2"-12		33,5	109,5	70				80

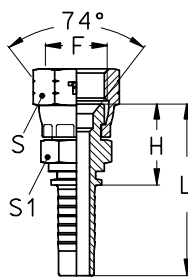

DKJ	JIC STRAIGHT FEMALE - 74° CONE SEAT - DOUBLE EXAGON SLANGKOPPELING WARTEL JIC - CONUS 74° - DUBBELE EXAGON											
	TIEFFE Part. N.	Hose I.D. Ø interno tubo			Thread Filetto	Dimensions (mm)						Maximum WP bar
		DN	Size	Inch		F	H	L	S	S1		
CP0404FIC	6	04	1/4"	7/16"-20		19	47,5	15	12			350
CP0404FIC-EX14	6	04	1/4"	7/16"-20		19	47,5	14	12			350
CP0405FIC	6	04	1/4"	1/2"-20		19	47,5	17	14			350
CP0406FIC	6	04	1/4"	9/16"-18		23	51,5	19	14			250
CP0506FIC	8	05	5/16"	9/16"-18		23	51,5	19	14			250
CP0606FIC	10	06	3/8"	9/16"-18		23	53,4	19	15			250
CP0608FIC	10	06	3/8"	3/4"-16		23,5	54	24	19			250
CP0608FIC-EX22	10	06	3/8"	3/4"-16		23,5	54	22	19			250
CP0808FIC	12	08	1/2"	3/4"-16		24,5	57,5	24	19			250
CP0808FIC-EX22	12	08	1/2"	3/4"-16		24,5	57,5	22	19			250
CP0810FIC	12	08	1/2"	7/8"-14		25,5	58,5	27	22			200
CP1010FIC	16	10	5/8"	7/8"-14		25,5	61,5	27	22			200
CP1012FIC	16	10	5/8"	1 1/16"-12		28	64	32	27			200
CP1212FIC	20	12	3/4"	1 1/16"-12		29	70	32	27			200
CP1616FIC	25	16	1"	1 5/16"-12		35	90	41	32			160

DKJ90

J.I.C. 90° SWEPT ELBOW - 74° CONE SEAT - ONE PIECE - CRIMPED NUT
SLANGKOPPELING 90° J.I.C. - CONUS 74° - UIT EEN STUK, MOER GEPERST

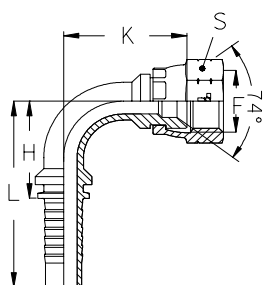

TIEFFE Part. N.	Hose I.D. Ø interno tubo			Thread Filetto	Dimensions (mm)					Maximum WP
	DN	Size	Inch	F	H	L	K	S		bar
XJF900703	5	03	3/16"	7/16"-20	21	47	22	15		350
XJF900703SW14	5	03	3/16"	7/16"-20	21	47	22	14		350
XJF900803	5	03	3/16"	1/2"-20	21	47	23	17		350
XJF900704	6	04	1/4"	7/16"-20	24	52	24	15		350
XJF900704SW14	6	04	1/4"	7/16"-20	24	52	24	14		350
XJF900804	6	04	1/4"	1/2"-20	24	52	25	17		350
XJF900904	6	04	1/4"	9/16"-18	23,5	52	27	19		250
XJF900805	8	05	5/16"	1/2"-20	31	59	29	17		350
XJF900905	8	05	5/16"	9/16"-18	30,5	59	30,5	19		250
XJF901205	8	05	5/16"	3/4"-16	30,5	59	33,5	24		250
XJF901205SW22	8	05	5/16"	3/4"-16	30,5	59	33,5	22		250
XJF900906	10	06	3/8"	9/16"-18	33,5	64	36,5	19		250
XJF901206	10	06	3/8"	3/4"-16	33,5	64	36	24		250
XJF901206SW22	10	06	3/8"	3/4"-16	33,5	64	36	22		250
XJF901406	10	06	3/8"	7/8"-14	33,5	64	38,5	27		200
XJF901208	12	08	1/2"	3/4"-16	41	74	40,5	24		250
XJF901208SW22	12	08	1/2"	3/4"-16	41	74	40,5	22		250
XJF901408	12	08	1/2"	7/8"-14	41	74	42	27		200
XJF901708	12	08	1/2"	1 1/16"-12	41	74	45,5	32		200
XJF901410	16	10	5/8"	7/8"-14	49	85	47	27		200
XJF901710	16	10	5/8"	1 1/16"-12	49	85	50,5	32		200
XJF901412	20	12	3/4"	7/8"-14	58	99	58	27		200
XJF901712	20	12	3/4"	1 1/16"-12	58	99	56,5	32		200
XJF901912	20	12	3/4"	1 3/16"-12	58	99	64	36		160
XJF902112	20	12	3/4"	1 5/16"-12	58	99	65	41		160
XJF901716	25	16	1"	1 1/16"-12	74	129	76	32		200
XJF902116	25	16	1"	1 5/16"-12	74	129	72	41		160
XJF902616	25	16	1"	1 5/8"-12	74	129	77	50		125
XJF902620	32	20	1 1/4"	1 5/8"-12	92	153	87	50		125
XJF903020	32	20	1 1/4"	1 7/8"-12	92	153	91	55		100
XJF903024	40	24	1 1/2"	1 7/8"-12	108	179	100	55		100
XJF904032	50	32	2"	2 1/2"-12	142	218	126	70		80

DKJ45

J.I.C. 45° SWEPT ELBOW - 74° CONE SEAT - ONE PIECE - CRIMPED NUT
SLANGKOPPELING 45° J.I.C. - CONUS 74° - UIT EEN STUK, MOER GEPERST

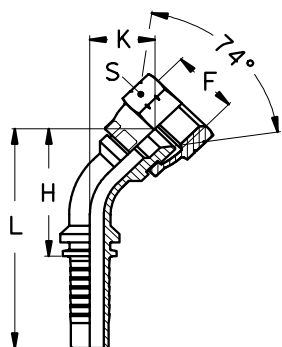

TIEFFE Part. N.	Hose I.D. Ø interno tubo			Thread Filetto	Dimensions (mm)						Maximum WP
	DN	Size	Inch	F	H	L	K	S			bar
XJF450703	5	03	3/16"	7/16"-20	34,5	60,5	13	15			350
XJF450703SW14	5	03	3/16"	7/16"-20	34,5	60,5	13	14			350
XJF450803	5	03	3/16"	1/2"-20	36	62	14,5	17			350
XJF450704	6	04	1/4"	7/16"-20	37	66	13,5	15			350
XJF450704SW14	6	04	1/4"	7/16"-20	37	66	13,5	14			350
XJF450804	6	04	1/4"	1/2"-20	38	67	14,5	17			350
XJF450904	6	04	1/4"	9/16"-18	39,5	68	15,5	19			250
XJF450805	8	05	5/16"	1/2"-20	46	74,5	16	17			350
XJF450905	8	05	5/16"	9/16"-18	47,5	76	17,5	19			250
XJF451205	8	05	5/16"	3/4"-16	49,5	77,5	19	24			250
XJF451205SW22	8	05	5/16"	3/4"-16	49,5	77,5	19	22			250
XJF450906	10	06	3/8"	9/16"-18	53,5	84	19,5	19			250
XJF451206	10	06	3/8"	3/4"-16	53,5	84	19,5	24			250
XJF451206SW22	10	06	3/8"	3/4"-16	53,5	84	19,5	22			250
XJF451406	10	06	3/8"	7/8"-14	55	85,5	21	27			200
XJF451208	12	08	1/2"	3/4"-16	61,5	94,5	22	24			200
XJF451208SW22	12	08	1/2"	3/4"-16	61,5	94,5	22	22			250
XJF451408	12	08	1/2"	7/8"-14	62,5	95,5	23	27			200
XJF451708	12	08	1/2"	1 1/16"-12	65	98	25,5	32			200
XJF451410	16	10	5/8"	7/8"-14	76	112	24	27			200
XJF451710	16	10	5/8"	1 1/16"-12	78,5	114,5	26	32			200
XJF451412	20	12	3/4"	7/8"-14	87	128	33,5	27			200
XJF451712	20	12	3/4"	1 1/16"-12	85,5	126,5	32	32			200
XJF451912	20	12	3/4"	1 3/16"-12	88,5	129,5	35	36			160
XJF452112	20	12	3/4"	1 5/16"-12	91	132	37,5	41			160
XJF451716	25	16	1"	1 1/16"-12	113	167,5	44,5	32			200
XJF452116	25	16	1"	1 5/16"-12	108	162,5	40	41			160
XJF452616	25	16	1"	1 5/8"-12	111	166	43	50			125
XJF452620	32	20	1 1/4"	1 5/8"-12	136	196,5	52	50			125
XJF453020	32	20	1 1/4"	1 7/8"-12	141	201,5	57	55			100
XJF453024	40	2'4	1 1/2"	1 7/8"-12	161	231	57	55			100
XJF454032	50	32	2"	2 1/2"-12	206	281	66,5	70			80

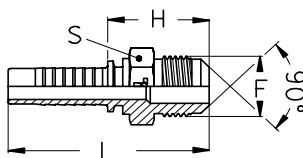
		SAE MALE - 90° CONE SLANGKOPPELING BU.DR. SAE - CONUS 90°									
TIEFFE Part. N.	Hose I.D. Ø interno tubo			Thread Filetto	Dimensions (mm)						
	DN	Size	Inch	F	H	L	S				
											
XMS1005	8	05	5/16"	5/8"-18	28,2	56,7	17				
XMS1006	10	06	3/8"	5/8"-18	28,2	58,7	17				
XMS1712	20	12	3/4"	1 1/16"-14	40,5	81,5	27				

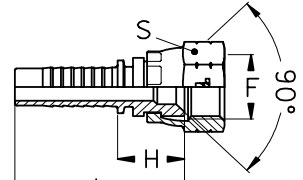
		SAE FEMALE - 90° CONE SEAT - CRIMPED NUT SLANGKOPPELING SAE - CONUS 90° - UIT EEN STUK, MOER GEPERST									
TIEFFE Part. N.	Hose I.D. Ø interno tubo			Thread Filetto	Dimensions (mm)						
	DN	Size	Inch	F	H	L	S				
											
XFS1005	8	05	5/16"	5/8"-18	17,6	46,1	22				
XFS1006	10	06	3/8"	5/8"-18	16,6	47,1	22				
XFS1712	20	12	3/4"	1 1/16"-14	23,2	64,2	32				

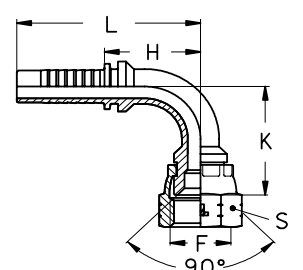
		SAE 90° SWEPT ELBOW - 90° CONE SEAT - ONE PIECE - CRIMPED NUT SLANGKOPPELING 90° SAE - CONUS 90° - UIT EEN STUK, MOER GEPERST									
TIEFFE Part. N.	Hose I.D. Ø interno tubo			Thread Filetto	Dimensions (mm)						
	DN	Size	Inch	F	H	L	K	S			
											
XFS901005	8	05	5/16"	5/8"-18	31	59	30	22			
XFS901006	10	06	3/8"	5/8"-18	34	64	33	22			
XFS901712	20	12	3/4"	1 1/16"-14	58	99	56	32			

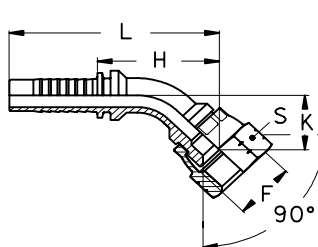
		SAE 45° SWEPT ELBOW - 90° CONE SEAT - ONE PIECE - CRIMPED NUT SLANGKOPPELING 45° SAE - CONUS 90° - UIT EEN STUK, MOER GEPERST									
TIEFFE Part. N.	Hose I.D. Ø interno tubo			Thread Filetto	Dimensions (mm)						
	DN	Size	Inch	F	H	L	K	S			
											
XFS451005	8	05	5/16"	5/8"-18	47	75	18	22			
XFS451006	10	06	3/8"	5/8"-18	50	81	18	22			
XFS451712	20	12	3/4"	1 1/16"-14	85	125	32	32			

TIEFFE Part. N.	ORFS FEMALE - LOOSE NUT SLANGKOPPELING WARTEL ORFS - LOSSE MOER										
	Hose I.D. Ø interno tubo			Thread Filetto	Dimensions (mm)						Maximum WP
	DN	Size	Inch	F	H	L	S				bar
XFU0904	6	04	1/4"	9/16"-18	21	49,5	17				450
XFU1104	6	04	1/4"	11/16"-16	23	51,5	22				450
XFU1105	8	05	5/16"	11/16"-16	23	51,5	22				350
XFU1106	10	06	3/8"	11/16"-16	23	53,5	22				445
XFU1306	10	06	3/8"	13/16"-16	26	56,5	24				445
XFU1308	12	08	1/2"	13/16"-16	26,5	59,5	24				415
XFU1608	12	08	1/2"	1"-14	30	63	30				415
XFU1908	12	08	1/2"	1 3/16"-12	33	66	36				415
XFU1610	16	10	5/8"	1"-14	30	66	30				350
XFU1910	16	10	5/8"	1 3/16"-12	33	69	36				350
XFU1912	20	12	3/4"	1 3/16"-12	33,5	74,5	36				350
XFU2312	20	12	3/4"	1 7/16"-12	34,5	75,5	41				350
XFU2316	25	16	1"	1 7/16"-12	35,5	90,5	41				280
XFU2720	32	20	1 1/4"	1 11/16"-12	36	97	50				210
XFU3224	40	24	1 1/2"	2"-12	36,5	107	60				185

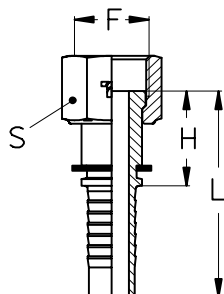

TIEFFE Part. N.	90° ORFS SWEPT ELBOW - ONE PIECE - LOOSE NUT SLANGKOPPELING 90° ORFS - EEN STUK - LOSSE MOER										
	Hose I.D. Ø interno tubo			Thread Filetto	Dimensions (mm)						Maximum WP
	DN	Size	Inch	F	H	L	K	S			bar
XFU900904	6	04	1/4"	9/16"-18	24	52	21	17			450
XFU901104	6	04	1/4"	11/16"-16	24	52	24	22			450
XFU901105	8	05	5/16"	11/16"-16	31	59	26,5	22			350
XFU901106	10	06	3/8"	11/16"-16	34	64	29,5	22			445
XFU901306	10	06	3/8"	13/16"-16	34	64	32,5	24			445
XFU901308	12	08	1/2"	13/16"-16	41	74	35,5	24			415
XFU901608	12	08	1/2"	1"-14	41	74	39	30			415
XFU901908	12	08	1/2"	1 3/16"-12	41	74	42	36			415
XFU901610	16	10	5/8"	1"-14	49	85	43,5	30			350
XFU901910	16	10	5/8"	1 3/16"-12	49	85	46,5	36			350
XFU901912	20	12	3/4"	1 3/16"-12	58	99	52	36			350
XFU902312	20	12	3/4"	1 7/16"-12	58	99	56	41			350
XFU902316	25	16	1"	1 7/16"-12	74	129	61,5	41			280
XFU902720	32	20	1 1/4"	1 11/16"-12	92	153	73,5	50			210
XFU903224	40	24	1 1/2"	2"-12	108	179	82,5	60			185

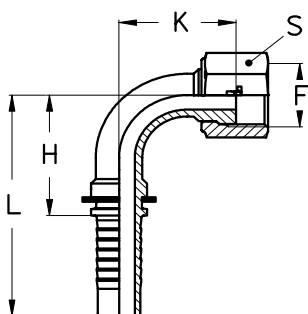

ORFS45

45° ORFS SWEPT ELBOW - ONE PIECE - LOOSE NUT SLANGKOPPELING 45° ORFS - EEN STUK - LOSSE MOER

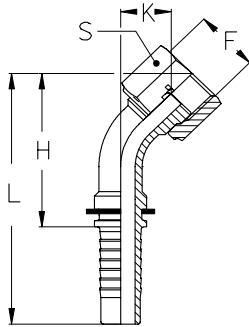

TIEFFE Part. N.	Hose I.D. Ø interno tubo			Thread Filetto	Dimensions (mm)					Maximum WP bar
	DN	Size	Inch	F	H	L	K	S		
XFU450904	6	04	1/4"	9/16"-18	35,5	64	11,5	17		450
XFU451104	6	04	1/4"	11/16"-16	37	65,5	13	22		450
XFU451105	8	05	5/16"	11/16"-16	44,5	73	14	22		350
XFU451106	10	06	3/8"	11/16"-16	48,5	79	14,5	22		445
XFU451306	10	06	3/8"	13/16"-16	51	81,5	17	24		445
XFU451308	12	08	1/2"	13/16"-16	58	91	18,5	24		415
XFU451608	12	08	1/2"	1"-14	60	93	21	30		415
XFU451908	12	08	1/2"	1 3/16"-12	62,5	95,5	23	36		415
XFU451610	16	10	5/8"	1"-14	73,5	109,5	21	30		350
XFU451910	16	10	5/8"	1 3/16"-12	75,7	111,5	23,5	36		350
XFU451912	20	12	3/4"	1 3/16"-12	82,5	123,5	29	36		350
XFU452312	20	12	3/4"	1 7/16"-12	85,5	126,5	32	41		350
XFU452316	25	16	1"	1 7/16"-12	103	157,5	34,5	41		280
XFU452720	32	20	1 1/4"	1 11/16"-12	127	187,5	43	50		210
XFU453224	40	24	1 1/2"	2"-12	141	219,5	45	60		185

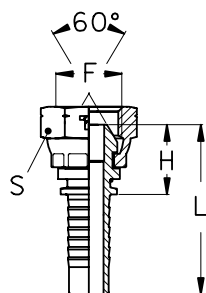

DKM

METRIC FEMALE - 60° CONE - CRIMPED NUT SLANGKOPPELING METRISCH - CONUS 60° - GEPERSTE MOER

TIEFFE Part. N.	Hose I.D. Ø interno tubo			Thread Filetto F	Dimensions (mm)				
	DN	Size	Inch		H	L	S		
XF61003	5	4,8	3/16"	M10x1	19	44	14		
XF61203	5	4,8	3/16"	M12x1,5	19	44	15		
XF61004	6	6,3	1/4"	M10X1	19	47	14		
XF61204	6	6,3	1/4"	M12x1,5	19	47	15		
XF61404	6	6,3	1/4"	M14x1,5	18	47	17		
XF61604	6	6,3	1/4"	M16x1,5	20	49	22		
XF61804	6	6,3	1/4"	M18x1,5	20	49	22		
XF61405	8	7,9	5/16"	M14x1,5	18	47	17		
XF61605	8	7,9	5/16"	M16x1,5	20	49	22		
XF61805	8	7,9	5/16"	M18x1,5	20	49	22		
XF61406	10	9,5	3/8"	M14x1,5	18	49	17		
XF61606	10	9,5	3/8"	M16x1,5	20	51	22		
XF61806	10	9,5	3/8"	M18x1,5	20	51	22		
XF62006	10	9,5	3/8"	M20x1,5	22	53	27		
XF62206	10	9,5	3/8"	M22x1,5	22	53	27		
XF61808	12	12,7	1/2"	M18x1,5	21	54	22		
XF62008	12	12,7	1/2"	M20x1,5	23	56	27		
XF62208	12	12,7	1/2"	M22x1,5	23	56	27		
XF62408	12	12,7	1/2"	M24x1,5	23	56	30		
XF62608	12	12,7	1/2"	M26x1,5	25	58	32		
XF62610	16	15,9	5/8"	M26x1,5	25	61	32		
XF62612	20	19,1	3/4"	M26x1,5	26	67	32		
XF63012	20	19,1	3/4"	M30x1,5	26	67	36		
XF63816	25	25,4	1"	M38x1,5	30	85	46		
XF64520	32	31,8	1 1/4"	M45x1,5	34	95	50		

DKM90

METRIC 90° SWEPT ELBOW - 60° CONE - ONE PIECE - CRIMPED NUT SLANGKOPPELING 90° METRISCH - CONUS 60° - 1 STUK - GEPERSTE MOER

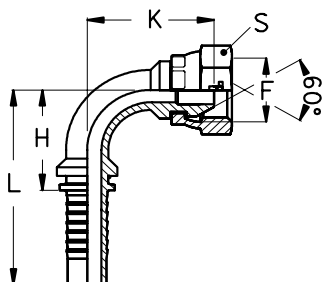

TIEFFE Part. N.	Hose I.D. Ø interno tubo			Thread Filetto F	Dimensions (mm)				
	DN	Size	Inch		H	L	K	S	
XF6901003	5	4,8	3/16"	M10x1	21	47	25	14	
XF6901203	5	4,8	3/16"	M12x1,5	21	47	28	15	
XF6901004	6	6,3	1/4"	M10X1	24	52	16	14	
XF6901204	6	6,3	1/4"	M12x1,5	24	52	28	15	
XF6901404	6	6,3	1/4"	M14x1,5	24	52	28	17	
XF6901604	6	6,3	1/4"	M16x1,5	24	52	31	22	
XF6901804	6	6,3	1/4"	M18x1,5	24	52	31	22	
XF6901405	8	7,9	5/16"	M14x1,5	31	59	31,5	17	
XF6901605	8	7,9	5/16"	M16x1,5	31	59	33,5	22	
XF6901805	8	7,9	5/16"	M18x1,5	31	59	33,5	22	
XF6901406	10	9,5	3/8"	M14x1,5	34	64	35,5	17	
XF6901606	10	9,5	3/8"	M16x1,5	34	64	40,5	22	
XF6901806	10	9,5	3/8"	M18x1,5	34	64	40,5	22	
XF6902006	10	9,5	3/8"	M20x1,5	34	64	40,5	27	
XF6902206	10	9,5	3/8"	M22x1,5	34	64	40,5	27	
XF6901808	12	12,7	1/2"	M18x1,5	41	74	42	22	
XF6902008	12	12,7	1/2"	M20x1,5	41	74	44	27	
XF6902208	12	12,7	1/2"	M22x1,5	41	74	44	27	
XF6902408	12	12,7	1/2"	M24x1,5	41	74	45,5	30	
XF6902608	12	12,7	1/2"	M26x1,5	41	74	49,5	32	
XF6902610	16	15,9	5/8"	M26x1,5	49	85	54,5	32	
XF6902612	20	19,1	3/4"	M26x1,5	58	99	60,5	32	
XF6903012	20	19,1	3/4"	M30x1,5	58	99	65	36	
XF6903816	25	25,4	1"	M38x1,5	74	129	79	46	
XF6904520	32	31,8	1 1/4"	M45x1,5	92	179	89	50	

DKM45

METRIC 45° SWEEP ELBOW - 60° CONE - ONE PIECE - CRIMPED NUT SLANGKOPPELING 45° METRISCH - CONUS 60° - 1 STUK - MOER GEPERST

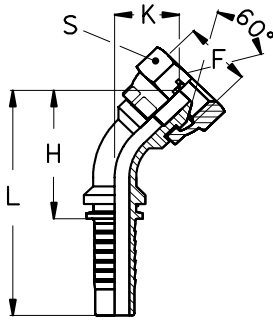

TIEFFE Part. N.	Hose I.D. Ø interno tubo			Thread Filetto	Dimensions (mm)				Maximum WP bar
	DN	Size	Inch	F	H	L	K	S	
XF6451003	5	4,8	3/16"	M10x1	36	61,5	14	14	
XF6451203	5	4,8	3/16"	M12x1,5	37,5	63	15,5	15	
XF6451004	6	6,3	1/4"	M10x1	39	67,5	15	14	
XF6451204	6	6,3	1/4"	M12x1,5	40	68,5	16,5	15	
XF6451404	6	6,3	1/4"	M14x1,5	40	68,5	16,5	17	
XF6451604	6	6,3	1/4"	M16x1,5	42,5	71	18,5	22	
XF6451804	6	6,3	1/4"	M18x1,5	42,5	71	18,5	22	
XF6451405	8	7,9	5/16"	M14x1,5	48	76,5	18	17	
XF6451605	8	7,9	5/16"	M16x1,5	49,5	78	19,5	22	
XF6451805	8	7,9	5/16"	M18x1,5	49,5	78	19,5	22	
XF6451406	10	9,5	3/8"	M14x1,5	53	83,5	19	17	
XF6451606	10	9,5	3/8"	M16x1,5	53,5	84	19,5	22	
XF6451806	10	9,5	3/8"	M18x1,5	53,5	84	19,5	22	
XF6452006	10	9,5	3/8"	M20x1,5	56,5	87	22,5	27	
XF6452206	10	9,5	3/8"	M22x1,5	56,5	87	22,5	27	
XF6451808	12	12,7	1/2"	M18x1,5	62,5	95,5	23	22	
XF6452008	12	12,7	1/2"	M20x1,5	64	97	24,5	27	
XF6452208	12	12,7	1/2"	M22x1,5	64	97	24,5	27	
XF6452408	12	12,7	1/2"	M24x1,5	65	98	25,5	30	
XF6452608	12	12,7	1/2"	M26x1,5	67,5	101	28	32	
XF6452610	16	15,9	5/8"	M26x1,5	81	117	29	32	
XF6452612	20	19,1	3/4"	M26x1,5	88,5	130	35	32	
XF6453012	20	19,1	3/4"	M30x1,5	91	132	38,5	36	
XF6453816	25	25,4	1"	M38x1,5	114	169	46	46	
XF6454520	32	31,8	1 1/4"	M45x1,5	138	199	54	50	

DIN 20078/3868		DKL		METRIC FEMALE - MULTISEAL METRISCH WARTEL - MULISEAL									
TIEFFE Part.N.	Hose I.D. Ø interno tubo			Thread Filettatura	Tube	Dimensions (mm)					Maximum W.P.		
	DN	Size	Inch	F	mm	H	L	S			bar	PSI	
XFE140804	6	04	1/4"	M14x1,5	8	20	48	17			280	4000	
XFE161004	8	05	5/16"	M16x1,5	10	20	48	19			280	4000	
XFE181206	10	06	3/8"	M18x1,5	12	20	50	22			280	4000	
XFE221508	12	08	1/2"	M22x1,5	15	21	54	27			280	4000	
XFE261810	16	10	5/8"	M26x1,5	18	23	58	32			210	3000	

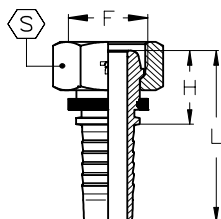

DIN 20078/3868		DKL45		45° METRIC SWEPT ELBOW - MULTISEAL SLANGKOPPELING BOCHT 45° METRISCH - MULTISEAL									
TIEFFE Part.N.	Hose I.D. Ø interno tubo			Thread Filettatura	Tube	Dimensions (mm)					Maximum W.P.		
	DN	Size	Inch	F	mm	H	L	K	S			bar	PSI
XFE45140804	6	04	1/4"	M14x1,5	8	35	63	13	17			280	4000
XFE45161005	8	05	5/16"	M16x1,5	10	37	65	15	19			280	4000
XFE45181206	10	06	3/8"	M18x1,5	12	39	69	15	22			280	4000
XFE45221508	12	08	1/2"	M22x1,5	15	45	78	17	27			280	4000
XFE45261810	16	10	5/8"	M26x1,5	18	52	87	20	32			210	3000

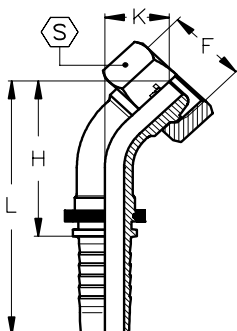

DIN 20078/3868		DKL90		90° METRIC SWEPT ELBOW - MULTISEAL SLANGKOPPELING 90° METRISCH - MULTISEAL									
TIEFFE Part.N.	Hose I.D. Ø interno tubo			Thread Filettatura	Tube	Dimensions (mm)					Maximum W.P.		
	DN	Size	Inch	F	mm	H	L	K	S			bar	PSI
XFE90140804	6	04	1/4"	M14x1,5	8	29	57	27	17			280	4000
XFE90161005	8	05	5/16"	M16x1,5	10	31	59	30	19			280	4000
XFE90181206	10	06	3/8"	M18x1,5	12	31	61	30	22			280	4000
XFE90221508	12	08	1/2"	M22x1,5	15	37	70	36	27			280	4000
XFE90261810	16	10	5/8"	M26x1,5	18	45	81	42	32			210	3000

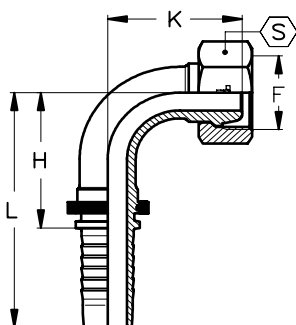

METRIC BANJO - ONEPIECE METRISCHE BANJO - UIT 1 DEEL

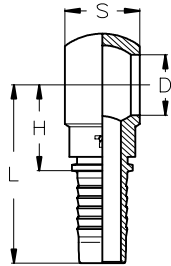

TIEFFE Part.N.	Hose I.D. Ø interno tubo			Thread Filettatura	Dimensions (mm)				
	DN	Size	Inch	F	H	L	D	S	
XQB0203	5	03	3/16"	M10x1	20	45	10,2	10	
XQE1203	5	03	3/16"	M12x1,5	21,1	46,1	12,1	12	
XQE1403	5	03	3/16"	M14x1,5	22,6	47,6	14,2	14	
XQB0204	6	04	1/4"	M10x1	23	51	10,2	10	
XQE1204	6	04	1/4"	M12x1,5	23	51	12,1	12	
XQE1404	6	04	1/4"	M14x1,5	23	51	14	14	
XQE1604	6	04	1/4"	M16x1,5	26,5	54,5	16,2	17,5	
XQE1804	6	04	1/4"	M18x1,5	28,5	56,5	18,2	20,5	
XQE1205	8	05	5/16"	M12x1,5	23,5	51,5	12,1	12	
XQE1405	8	05	5/16"	M14x1,5	24	52	14,2	14	
XQE1605	8	05	5/16"	M16x1,5	26,5	54,5	16,2	17,5	
XQE1805	8	05	5/16"	M18x1,5	28,5	56,5	18,2	20,5	
XQE1406	10	06	3/8"	M14x1,5	24	54,5	14,2	14	
XQE1606	10	06	3/8"	M16x1,5	24	54,5	16,2	17,5	
XQE1806	10	06	3/8"	M18x1,5	27	57,5	18,2	20,5	
XQE2006	10	06	3/8"	M20x1,5	32	62,5	20,2	23	
XQE2206	10	06	3/8"	M22x1,5	32	62,5	22,2	22,5	
XQB1208	12	08	1/2"	M26x1,5	39	72	26,5	29,5	
XQE1808	12	08	1/2"	M18x1,5	28,1	61,1	18,2	20,5	
XQE2008	12	08	1/2"	M20x1,5	28,5	61,5	20,2	23	
XQE2208	12	08	1/2"	M22x1,5	28,5	61,5	22,2	22,5	
XQB1210	16	10	5/8"	M26x1,5	34,7	70,5	26,5	29,5	
XQE2210	16	10	5/8"	M22x1,5	27,2	63	22,2	22,5	
XQB1212	20	12	3/4"	M26x1,5	37,5	78	26,5	29,5	
XQE3012	20	12	3/4"	M30x1,5	41,5	82	30,2	30	
XQE3016	25	16	1"	M30x1,5	43	94	30,2	37	

METRIC BANJO BOLT METRISCHE BANJO BOUT

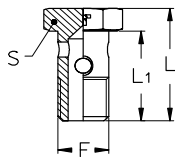

TIEFFE Part.N.	Thread Filettatura	Dimensions (mm)		
		L	L1	S
QME10	M10x1	26	21,5	14
QME12	M12x1,5	31	25,5	17
QME14	M14x1,5	37,5	30,5	19
QME16	M16x1,5	40	32,5	22
QME18	M18x1,5	44	36,5	24
QME20	M20x1,5	48	39,5	27
QME22	M22x1,5	50	41,5	28
QME26	M26x1,5	58	48,5	32
QME30	M30x1,5	64	53	36

ISO 12151-2
DIN 20078

CEL

METRIC MALE - 24° CONE SEAT - LIGHT DUTY
METRISCHE BU.DR. KOPPELING - 24° CONUS - LICHTE SERIE

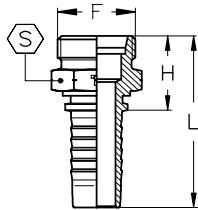

TIEFFE Part.N.	Hose I.D. Ø interno tubo			Thread Filettatura	Tube	Dimensions (mm)				Maximum W.P.	
	DN	Size	Inch	F	mm	H	L	S		bar	PSI
	XME120603	5	03	3/16"	M12x1,5	6	21	46	12		280
XME140803	5	03	3/16"	M14x1,5	8	21	46	14		280	4000
XME120604	6	04	1/4"	M12x1,5	6	21	49	12		280	4000
XME140804	6	04	1/4"	M14x1,5	8	21	49	14		280	4000
XME161004	6	04	1/4"	M16x1,5	10	23	51	17		280	4000
XME181204	6	04	1/4"	M18x1,5	12	23	51	19		280	4000
XME161005	8	05	5/16"	M16x1,5	10	23	51	17		280	4000
XME181205	8	05	5/16"	M18x1,5	12	23	51	19		280	4000
XME161006	10	06	3/8"	M16x1,5	10	23	53	17		280	4000
XME181206	10	06	3/8"	M18x1,5	12	23	53	19		280	4000
XME221506	10	06	3/8"	M22x1,5	15	25	56	22		280	4000
XME221508	12	08	1/2"	M22x1,5	15	26	59	22		280	4000
XME261808	12	08	1/2"	M26x1,5	18	28	61	27		210	3000
XME261810	16	10	5/8"	M26x1,5	18	28	64	27		210	3000
XME302210	16	10	5/8"	M30x2	22	30	66	30		210	3000
XME261812	20	12	3/4"	M26x1,5	18	29	70	27		210	3000
XME302212	20	12	3/4"	M30x2	22	31	72	30		210	3000
XME362816	25	16	1"	M36x2	28	35	86	36		165	2350
XME453520	32	20	1 1/4"	M45x2	35	40	97	46		125	1800
XME524224	40	24	1 1/2"	M52x2	42	42	106	55		100	1450

ISO 12151-2
DIN 20078

CES

METRIC MALE - 24° CONE SEAT - HEAVY DUTY
METRISCHE BU.DR. KOPPELING - 24° CONUS - ZWARE SERIE

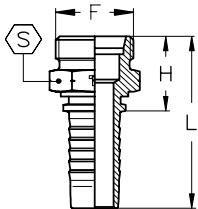

TIEFFE Part.N.	Hose I.D. Ø interno tubo			Thread Filettatura	Tube	Dimensions (mm)				Maximum W.P.	
	DN	Size	Inch	F	mm	H	L	S		bar	PSI
	XME140603	5	03	3/16"	M14x1,5	6	23	48	14		420
XME160803	5	03	3/16"	M16x1,5	8	23	48	17		420	6000
XME140604	6	04	1/4"	M14x1,5	6	23	51	14		450	6500
XME160804	6	04	1/4"	M16x1,5	8	23	51	17		450	6500
XME181004	6	04	1/4"	M18x1,5	10	24	52	19		450	6500
XME201204	6	04	1/4"	M20x1,5	12	25	53	22		450	6500
XME181005	8	05	5/16"	M18x1,5	10	24	52	19		350	5000
XME201205	8	05	5/16"	M20x1,5	12	25	53	22		350	5000
XME181006	10	06	3/8"	M18x1,5	10	24	55	19		450	6500
XME201206	10	06	3/8"	M20x1,5	12	25	56	22		450	6500
XME221406	10	06	3/8"	M22x1,5	14	27	58	22		450	6500
XME221408	12	08	1/2"	M22x1,5	14	28	61	22		420	6000
XME241608	12	08	1/2"	M24x1,5	16	29	62	24		420	6000
XME302010	16	10	5/8"	M30x2	20	32	68	30		350	5000
XME302012	20	12	3/4"	M30x2	20	33	74	30		350	5000
XME362512	20	12	3/4"	M36x2	25	37	78	36		350	5000
XME362516	25	16	1"	M36x2	25	39	90	36		280	4000
XME423016	25	16	1"	M42x2	30	43	94	46		280	4000
XME423020	32	20	1 1/4"	M42x2	30	44	101	46		210	3000
XME523820	32	20	1 1/4"	M52x2	38	48	105	55		210	3000
XME523824	40	24	1 1/2"	M52x2	38	48	112	55		185	2600

ISO 12151-2 DIN 20078	DKOL	METRIC FEMALE - 24° O-RING CONE - LIGHT DUTY METRISCHE WARTELKOPPELING - CONUS 24° O-RING - LICHTE SERIE												
		TIEFFE Part.N.	Hose I.D. Ø interno tubo			Thread Filettatura	Tube	Dimensions (mm)					Maximum W.P.	
			DN	Size	Inch	F	mm	H	L	S	O'Ring	bar	PSI	
	XFEO120603	5	03	3/16"	M12x1,5	6	21	46	14		5x1	280	4000	
	XFEO140803	5	03	3/16"	M14x1,5	8	21	46	17		6x1,5	280	4000	
	XFEO120604	6	04	1/4"	M12x1,5	6	23	51	17		5x1	280	4000	
	XFEO140804	6	04	1/4"	M14x1,5	8	22	50	17		6x1,5	280	4000	
	XFEO161004	6	04	1/4"	M16x1,5	10	24	52	19		7,5x1,5	280	4000	
	XFEO181204	6	04	1/4"	M18x1,5	12	24	52	22		9x1,5	280	4000	
	XFEO161005	8	05	5/16"	M16x1,5	10	24	52	19		7,5x1,5	280	4000	
	XFEO181205	8	05	5/16"	M18x1,5	12	24	52	22		9x1,5	280	4000	
	XFEO161006	10	06	3/8"	M16x1,5	10	23	54	19		7,5x1,5	280	4000	
	XFEO181206	10	06	3/8"	M18x1,5	12	24	54	22		9x1,5	280	4000	
	XFEO221506	10	06	3/8"	M22x1,5	15	24	54	27		12x2	280	4000	
	XFEO221508	12	08	1/2"	M22x1,5	15	24	57	27		12x2	280	4000	
	XFEO261808	12	08	1/2"	M26x1,5	18	26	59	32		15x2	210	3000	
	XFEO261810	16	10	5/8"	M26x1,5	18	27	62	32		15x2	210	3000	
	XFEO302210	16	10	5/8"	M30x2	22	28	64	36		20x2	210	3000	
	XFEO261812	20	12	3/4"	M26x1,5	18	34	75	32		15x2	210	3000	
	XFEO302212	20	12	3/4"	M30x2	22	31	71	36		20x2	210	3000	
	XFEO362816	25	16	1"	M36x2	28	32	83	41		26x2	165	2350	
	XFEO453520	32	20	1 1/4"	M45x2	35	36	94	50		32x2,5	125	1800	
	XFEO524224	40	24	1 1/2"	M52x2	42	37	102	60		38x2,5	100	1450	

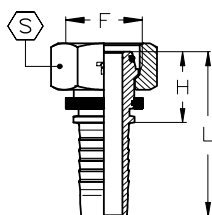

* Swaged nut

** Tieffe nut

ISO 12151-2 DIN 20078	DKOS	METRIC FEMALE - 24° O-RING CONE - HEAVY DUTY METRISCHE WARTELKOPPELING - CONUS 24° O-RING - ZWARE SERIE												
		TIEFFE Part.N.	Hose I.D. Ø interno tubo			Thread Filettatura	Tube	Dimensions (mm)					Maximum W.P.	
			DN	Size	Inch	F	mm	H	L	S	O'Ring	bar	PSI	
	XFEO140603	5	03	3/16"	M14x1,5	6	21	46	17		5x1	420	6000	
	XFEO160803	5	03	3/16"	M16x1,5	8	21	46	19		6x1,5	420	6000	
	XFEO140604	6	04	1/4"	M14x1,5	6	23	51	17		5x1	450	6500	
	XFEO160804	6	04	1/4"	M16x1,5	8	22	50	19		6x1,5	450	6500	
	XFEO181004	6	04	1/4"	M18x1,5	10	24	52	22		7,5x1,5	450	6500	
	XFEO201204	6	04	1/4"	M20x1,5	12	24	52	24		9x1,5	450	6500	
	XFEO181005	8	05	5/16"	M18x1,5	10	24	52	22		7,5x1,5	350	5000	
	XFEO201205	8	05	5/16"	M20x1,5	12	24	52	24		9x1,5	350	5000	
	XFEO181006	10	06	3/8"	M18x1,5	10	25	55	22		7,5x1,5	450	6500	
	XFEO201206	10	06	3/8"	M20x1,5	12	24	54	24		9x1,5	450	6500	
	XFEO221406	10	06	3/8"	M22x1,5	14	28	58	27		10x2	450	6500	
	XFEO221408	12	08	1/2"	M22x1,5	14	28	61	27		10x2	420	6000	
	XFEO241608	12	08	1/2"	M24x1,5	16	29	62	30		12x2	420	6000	
	XFEO302010	16	10	5/8"	M30x2	20	33	69	36		16,3x2,4	350	5000	
	XFEO302012	20	12	3/4"	M30x2	20	36	76	36		16,3x2,4	350	5000	
	XFEO362512	20	12	3/4"	M36x2	25	38	78	46		20,3x2,4	350	5000	
	XFEO362512SW41	20	12	3/4"	M36x2	25	38	78	41		20,3x2,4	350	5000	
	XFEO362516	25	16	1"	M36x2	25	40	91	46		22x2	280	4000	
	XFEO423016	25	16	1"	M42x2	30	40	91	50		25,3x2,4	280	4000	
	XFEO423020	32	20	1 1/4"	M42x2	30	41	99	50		25,3x2,4	210	3000	
	XFEO523820	32	20	1 1/4"	M52x2	38	45	103	60		33,3x2,4	210	3000	
	XFEO523824	40	24	1 1/2"	M52x2	38	46	110	60		33,3x2,4	185	2600	

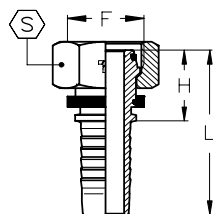

* Swaged nut

ISO 12151-2 DIN 20078	DKOL45	45° METRIC SWEPT ELBOW - 24° O-RING CONE - LIGHT DUTY METRISCHE BOCHT 45° - 24° CONUS MET ORING - LICHTE SERIE												
		TIEFFE Part.N.	Hose I.D. Ø interno tubo			Thread Filettatura	Tube	Dimensions (mm)					Maximum W.P.	
			DN	Size	Inch	F	mm	H	L	K	S	O'Ring	bar	PSI
	XFEO45120603	5	03	3/16"	M12x1,5	6	34	59	14	14	5x1	280	4000	
	XFEO45140803	5	03	3/16"	M14x1,5	8	35	60	14	17	6x1,5	280	4000	
	XFEO45120604	6	04	1/4"	M12x1,5	6	35	63	14	17	5x1	280	4000	
	XFEO45140804	6	04	1/4"	M14x1,5	8	36	64	14	17	6x1,5	280	4000	
	XFEO45161004	6	04	1/4"	M16x1,5	10	38	66	16	19	7,5x1,5	280	4000	
	XFEO45181204	6	04	1/4"	M18x1,5	12	39	67	17	22	9x1,5	280	4000	
	XFEO45161005	8	05	5/16"	M16x1,5	10	39	67	17	19	7,5x1,5	280	4000	
	XFEO45181205	8	05	5/16"	M18x1,5	12	39	67	18	22	9x1,5	280	4000	
	XFEO45161005	10	06	3/8"	M16x1,5	10	39	69	16	19	7,5x1,5	280	4000	
	XFEO45181206	10	06	3/8"	M18x1,5	12	40	71	18	22	9x1,5	280	4000	
	XFEO45221506	10	06	3/8"	M22x1,5	15	42	72	19	27	12x2	280	4000	
	XFEO45221508	12	08	1/2"	M22x1,5	15	46	79	19	27	12x2	280	4000	
	XFEO45261808	12	08	1/2"	M26x1,5	18	47	80	21	32	15x2	210	3000	
	XFEO45261810	16	10	5/8"	M26x1,5	18	53	89	22	32	15x2	210	3000	
	XFEO45302210	16	10	5/8"	M30x2	22	54	90	23	36	20x2	210	3000	
	XFEO45261812	20	12	3/4"	M26x1,5	18	66	107	29	32	15x2	210	3000	
	XFEO45302212	20	12	3/4"	M30x2	22	62	103	25	36	20x2	210	3000	
	XFEO45362816	25	16	1"	M36x2	28	80	131	31	41	26x2	165	2350	
	XFEO45453520	32	20	1 1/4"	M45x2	35	96	154	40	50	32x2,5	125	1800	
	XFEO45524224	40	24	1 1/2"	M52x2	42	115	179	48	60	38x2,5	100	1450	

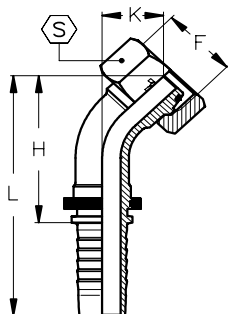

* Swaged nut

** Tieffe nut

ISO 12151-2 DIN 20078	DKOS45	45° METRIC SWEPT ELBOW - 24° O-RING CONE - HEAVY DUTY METRISCHE BOCHT 45° - 24° CONUS MET ORING - ZWARE SERIE												
		TIEFFE Part.N.	Hose I.D. Ø interno tubo			Thread Filettatura	Tube	Dimensions (mm)					Maximum W.P.	
			DN	Size	Inch	F	mm	H	L	K	S	O'Ring	bar	PSI
	XFEO45140603	5	03	3/16"	M14x1,5	6	34	59	14	17	5x1	420	6000	
	XFEO45160803	5	03	3/16"	M16x1,5	8	35	60	14	19	6x1,5	420	6000	
	XFEO45140604	6	04	1/4"	M14x1,5	6	35	63	14	17	5x1	450	6500	
	XFEO45160804	6	04	1/4"	M16x1,5	8	36	64	14	19	6x1,5	450	6500	
	XFEO45181004	6	04	1/4"	M18x1,5	10	38	66	16	22	7,5x1,5	450	6500	
	XFEO45201204	6	04	1/4"	M20x1,5	12	39	67	17	24	9x1,5	450	6500	
	XFEO45181005	8	05	5/16"	M18x1,5	10	39	67	17	22	7,5x1,5	350	5000	
	XFEO45201205	8	05	5/16"	M20x1,5	12	39	67	18	24	9x1,5	350	5000	
	XFEO45181006	10	06	3/8"	M18x1,5	10	40	70	17	22	7,5x1,5	450	6500	
	XFEO45201206	10	06	3/8"	M20x1,5	12	40	71	18	24	9x1,5	450	6500	
	XFEO45221406	10	06	3/8"	M22x1,5	14	42	72	19	27	10x2	450	6500	
	XFEO45221408	12	08	1/2"	M22x1,5	14	46	79	20	27	10x2	420	6000	
	XFEO45241608	12	08	1/2"	M24x1,5	16	47	80	21	30	12x2	420	6000	
	XFEO45302010	16	10	5/8"	M30x2	20	56	92	25	36	16,3x2,4	350	5000	
	XFEO45302012	20	12	3/4"	M30x2	20	64	105	27	36	16,3x2,4	350	5000	
	XFEO45362512	20	12	3/4"	M36x2	25	64	105	28	46	20,3x2,4	350	5000	
	XFEO45362512SW41	20	12	3/4"	M36x2	25	64	105	28	41	20,3x2,4	350	5000	
	XFEO45362516	25	16	1"	M36x2	25	82	133	34	41	22x2	280	4000	
	XFEO45423016	25	16	1"	M42x2	30	80	131	31	50	25,3x2,4	280	4000	
	XFEO45423020	32	20	1 1/4"	M42x2	30	96	154	41	50	25,3x2,4	210	3000	
	XFEO45523820	32	20	1 1/4"	M52x2	38	94	152	38	60	33,3x2,4	210	3000	
	XFEO45523824	40	24	1 1/2"	M52x2	38	115	180	49	60	33,3x2,4	185	2600	

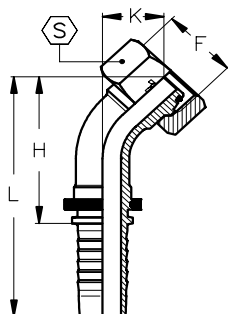

* Swaged nut

ISO 12151-2 DIN 20078		DKOL90		90° METRIC SWEEP ELBOW - 24° O-RING CONE - LIGHT DUTY METRISCHE BOCHT 90° - 24° CONUS MET ORING - LICHTE SERIE									
TIEFFE Part.N.	Hose I.D. Ø interno tubo			Thread Filettatura	Tube	Dimensions (mm)					Maximum W.P.		
	DN	Size	Inch	F	mm	H	L	K	S	O'Ring	bar	PSI	
XFE090120603	5	03	3/16"	M12x1,5	6	27	52	28	14	5x1	280	4000	
XFE090140803	5	03	3/16"	M14x1,5	8	27	52	28	17	6x1,5	280	4000	
XFE090120604	6	04	1/4"	M12x1,5	6	26	53	26	17	5x1	280	4000	
XFE090140804	6	04	1/4"	M14x1,5	8	29	57	29	17	6x1,5	280	4000	
XFE090161004	6	04	1/4"	M16x1,5	10	29	57	30	19	7,5x1,5	280	4000	
XFE090181204	6	04	1/4"	M18x1,5	12	29	57	32	22	9x1,5	280	4000	
XFE090161005	8	05	5/16"	M16x1,5	10	31	59	33	19	7,5x1,5	280	4000	
XFE090181205	8	05	5/16"	M18x1,5	12	28	56	32	22	9x1,5	280	4000	
XFE090161006	10	06	3/8"	M16x1,5	10	31	61	31	19	7,5x1,5	280	4000	
XFE090181206	10	06	3/8"	M18x1,5	12	31	61	33	22	9x1,5	280	4000	
XFE090221506	10	06	3/8"	M22x1,5	15	31	61	35	27	12x2	280	4000	
XFE090221508	12	08	1/2"	M22x1,5	15	37	70	38	27	12x2	280	4000	
XFE090261808	12	08	1/2"	M26x1,5	18	37	70	40	32	15x2	210	3000	
XFE090261810	16	10	5/8"	M26x1,5	18	44	80	45	32	15x2	210	3000	
XFE090302210	16	10	5/8"	M30x2	22	44	80	47	36	20x2	210	3000	
XFE090261812	20	12	3/4"	M26x1,5	18	54	94	57	32	15x2	210	3000	
XFE090302212	20	12	3/4"	M30x2	22	54	94	52	36	20x2	210	3000	
XFE090362816	25	16	1"	M36x2	28	70	121	66	41	26x2	165	2350	
XFE090453520	32	20	1 1/4"	M45x2	35	84	141	83	50	32x2,5	125	1800	
XFE090524224	40	24	1 1/2"	M52x2	42	100	164	100	60	38x2,5	100	1450	

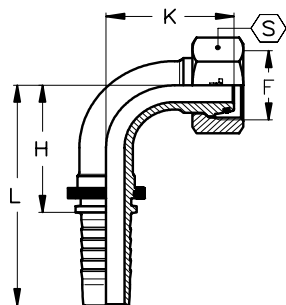

* Swaged nut

** Tieffe nut

ISO 12151-2 DIN 20078		DKOS90		90° METRIC SWEEP ELBOW - 24° O-RING CONE - HEAVY DUTY METRISCHE BOCHT 90° - 24° CONUS MET ORING - ZWARE SERIE									
TIEFFE Part.N.	Hose I.D. Ø interno tubo			Thread Filettatura	Tube	Dimensions (mm)					Maximum W.P.		
	DN	Size	Inch	F	mm	H	L	K	S	O'Ring	bar	PSI	
XFE090140603	5	03	3/16"	M14x1,5	6	27	52	28	17	5x1	420	6000	
XFE090160803	5	03	3/16"	M16x1,5	8	27	52	28	19	6x1,5	420	6000	
XFE090140604	6	04	1/4"	M14x1,5	6	25	53	26	17	5x1	450	6500	
XFE090160804	6	04	1/4"	M16x1,5	8	29	57	29	19	6x1,5	450	6500	
XFE090181004	6	04	1/4"	M18x1,5	10	29	57	30	22	7,5x1,5	450	6500	
XFE090201204	6	04	1/4"	M20x1,5	12	29	57	32	24	9x1,5	450	6500	
XFE090181005	8	05	5/16"	M18x1,5	10	31	59	33	22	7,5x1,5	350	5000	
XFE090201205	8	05	5/16"	M20x1,5	12	28	56	32	24	9x1,5	350	5000	
XFE090181006	10	06	3/8"	M18x1,5	10	30	61	33	22	7,5x1,5	450	6500	
XFE090201206	10	06	3/8"	M20x1,5	12	31	61	33	24	9x1,5	450	6500	
XFE090221406	10	06	3/8"	M22x1,5	14	34	64	37	27	10x2	450	6500	
XFE090221408	12	08	1/2"	M22x1,5	14	39	71	41	27	10x2	420	6000	
XFE090241608	12	08	1/2"	M24x1,5	16	39	71	42	30	12x2	420	6000	
XFE090302010	16	10	5/8"	M30x2	20	44	80	49	36	16,3x2,4	350	5000	
XFE090302012	20	12	3/4"	M30x2	20	54	94	55	36	16,3x2,4	350	5000	
XFE090362512	20	12	3/4"	M36x2	25	54	94	57	46	20,3x2,4	350	5000	
XFE090362512SW41	20	12	3/4"	M36x2	25	54	94	57	41	20,3x2,4	350	5000	
XFE090362516	25	16	1"	M36x2	25	70	121	70	46	22x2	280	4000	
XFE090423016	25	16	1"	M42x2	30	70	121	66	50	25,3x2,4	280	4000	
XFE090423020	32	20	1 1/4"	M42x2	30	84	141	84	50	25,3x2,4	210	3000	
XFE090523820	32	20	1 1/4"	M52x2	38	84	141	80	60	33,3x2,4	210	3000	
XFE090523824	40	24	1 1/2"	M52x2	38	100	164	101	60	33,3x2,4	185	2600	

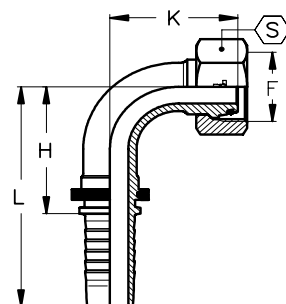

* Swaged nut

TIEFFE Part. N.	90° METRIC STANDPIPE - ONE PIECE STANDPIJP METRISCH 90° - UIT 1 STUK											
	Hose I.D. Ø interno tubo			E mm	Dimensions (mm)						Maximum WP bar	
	DN	Size	Inch		H	L	K	M				
BEL 90												
BES 90												
XEZ900603	5	03	3/16"	6	21	47	37,5	23				415
XEZ900803	5	03	3/16"	8	21	47	37,5	23				415
XEZ900604	6	04	1/4"	6	24	52	39	21				320
XEZ900804	6	04	1/4"	8	24	52	39	23				450
XEZ901004	6	04	1/4"	10	24	52	41	25				450
XEZ901204	6	04	1/4"	12	24	52	42,5	25				450
XEZ901005	8	05	5/16"	10	31	59	45	25				350
XEZ901205	8	05	5/16"	12	31	59	45	25				350
XEZ901006	10	06	3/8"	10	34	64	48	22				330
XEZ901206	10	06	3/8"	12	34	64	49	25				445
XEZ901406	10	06	3/8"	14	34	64	52	28				445
XEZ901506	10	06	3/8"	15	34	64	48	24				250
XEZ901408	12	08	1/2"	14	41	74	57,5	28				275
XEZ901508	12	08	1/2"	15	41	74	53,5	24				250
XEZ901608	12	08	1/2"	16	41	74	58,5	29				415
XEZ901808	12	08	1/2"	18	41	74	55,5	26				160
XEZ901810	16	10	5/8"	18	49	85	61,5	26				160
XEZ902010	16	10	5/8"	20	49	85	70,5	35				350
XEZ902210	16	10	5/8"	22	49	85	60	28				160
XEZ901812	20	12	3/4"	18	58	99	69	26				160
XEZ902012	20	12	3/4"	20	58	99	78	35				215
XEZ902212	20	12	3/4"	22	58	99	71	28				160
XEZ902512	20	12	3/4"	25	58	99	82	39				350
XEZ902516	25	16	1"	25	74	129	99	39				165
XEZ902816	25	16	1"	28	74	129	89	29				100
XEZ903010	25	16	1"	30	74	129	96	43				250
XEZ903020	32	20	1 1/4"	30	92	153	110	43				210
XEZ903520	32	20	1 1/4"	35	92	153	107	35				100
XEZ903820	32	20	1 1/4"	38	92	153	115	48				210
XEZ903824	40	24	1 1/2"	38	108	179	128	48				170
XEZ904224	40	24	1 1/2"	42	108	179	120	36				100

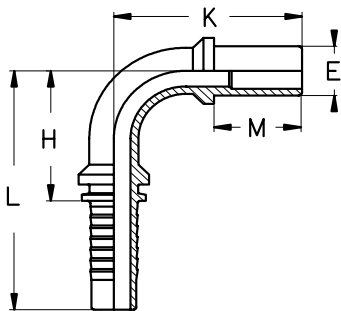

**BEL 45
BES 45**

**45° METRIC STANDPIPE - ONE PIECE
STANDPIJP METRISCH 45° - UIT 1 STUK**

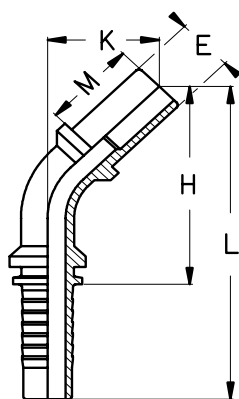

TIEFFE Part. N.	Hose I.D. Ø interno tubo			E mm	Dimensions (mm)						Maximum WP bar
	DN	Size	Inch		H	L	K	M			
XEZ450603	5	03	3/16"	6	44,5	70	22,5	23			415
XEZ450803	5	03	3/16"	8	44,5	70	22,5	23			415
XEZ450604	6	04	1/4"	6	48	77	24	21			320
XEZ450804	6	04	1/4"	8	48	76,5	24	23			450
XEZ451004	6	04	1/4"	10	49,5	78	25,5	25			450
XEZ451204	6	04	1/4"	12	50,5	79	26,5	25			450
XEZ451005	8	05	5/16"	10	51,5	80	27,5	25			350
XEZ451205	8	05	5/16"	12	57,5	86	27,5	25			350
XEZ451006	10	06	3/8"	10	62	92,5	27,5	22			330
XEZ451206	10	06	3/8"	12	62,5	93	28,5	25			445
XEZ451406	10	06	3/8"	14	64,5	95	30,5	28			445
XEZ451506	10	06	3/8"	15	61,5	92,5	27,5	24			250
XEZ451408	12	08	1/2"	14	73,5	106,5	34	28			275
XDEZ451508	12	08	1/2"	15	70,5	103,5	31	24			250
XEZ451608	12	08	1/2"	16	74	107	34,5	29			415
XEZ451808	12	08	1/2"	18	72	105	32,5	26			160
XEZ451810	16	10	5/8"	18	86,5	122,5	34	26			160
XEZ452010	16	10	5/8"	20	92,5	128,5	40,5	35			350
XEZ452210	16	10	5/8"	22	85,5	121,5	33	28			160
XEZ451812	20	12	3/4"	18	94,5	135,5	41	26			160
XEZ452012	20	12	3/4"	20	100,5	141,5	47	35			215
XEZ452212	20	12	3/4"	22	96	137	42,5	28			160
XEZ452512	20	12	3/4"	25	103,5	144,5	50	39			350
XEZ452516	25	16	1"	25	131	186	63	39			165
XEZ452816	25	16	1"	28	124	178	56	29			100
XEZ453016	25	16	1"	30	126,5	181,5	58,5	43			250
XEZ453020	32	20	1 1/4"	30	152,5	213,5	69	43			210
XEZ453520	32	20	1 1/4"	35	153	214	69	35			100
XEZ453820	32	20	1 1/4"	38	156	217	72,5	48			210
XEZ453824	40	24	1 1/2"	38	184	254	79	48			170
XEZ454224	40	24	1 1/2"	42	175	246	71	36			100

TIEFFE Part. N.	AGF METRIC MALE 24° CONE SEAT - FRENCH TYPE METRISCHE BU.DR. KOPPELING 24° CONUS - FRANSE SERIE									
	Hose I.D. Ø interno tubo			Thread Filetto	Tube	Dimensions (mm)				
	DN	Size	Inch	F	mm	H	L	E	S	
XMG201304	6	04	1/4"	M20x1,5	13,25	26,7	55,2	13,25	22	
XMG201305	8	05	5/16"	M20x1,5	13,25	26,7	55,2	13,25	22	
XMG201306	10	06	3/8"	M20x1,5	13,25	26,7	57,2	13,25	22	
XMG241706	10	06	3/8"	M24x1,5	16,75	30,2	60,7	16,75	27	
XMG241708	12	08	1/2"	M24x1,5	16,75	30,7	63,7	16,75	27	
XMG302108	12	08	1/2"	M30x1,5	21,25	31,2	64,2	21,25	32	
XMG302110	16	10	5/8"	M30x1,5	21,25	31,2	67,2	21,25	32	
XMG302112	20	12	3/4"	M30x1,5	21,25	31,7	73,2	21,25	32	
XMG362712	20	12	3/4"	M36x1,5	26,75	31,7	73,2	26,75	36	
XMG453316	25	16	1"	M45x1,5	33,50	37,2	92,2	33,50	46	
XMG453324	32	20	1 1/4"	M45x1,5	33,50	38,2	99,2	33,50	46	

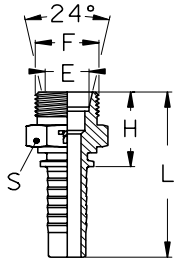

TIEFFE Part. N.	BEF STRAIGHT STANDPIPE - FRENCH TYPE STANDPIJP - FRANSE SERIE									
	Hose I.D. Ø interno tubo			E	Dimensions (mm)					
	DN	Size	Inch	mm	H	L	M			
XFZ1304	6	04	1/4"	13,25	29,5	58,0	22			
XFZ1305	8	05	5/16"	13,25	29,5	58,0	22			
XFZ1306	10	06	3/8"	13,25	29,5	60,0	22			
XFZ1706	10	06	3/8"	16,75	31,5	62,0	24			
XFZ1708	12	08	1/2"	16,75	32,5	65,5	24			
XFZ2108	12	08	1/2"	21,25	34,5	67,5	26			
XFZ2110	16	10	5/8"	21,25	34,5	70,5	26			
XFZ2112	20	12	3/4"	21,25	35,3	76,3	26			
XFZ2712	20	12	3/4"	26,75	34,3	75,3	25			
XFZ3316	25	16	1"	33,5	37,3	92,3	27			
XFZ3320	32	20	1 1/4"	33,5	38,0	99,0	27			

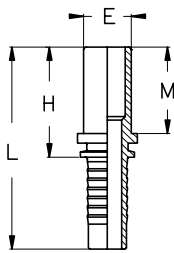

TIEFFE Part. N.	DKF METRIC FEMALE - 24° CONE - LOOSE NUT - FRENCH TYPE METRISCHE SLANGKOPPELING 24° CONUS - FRANSE SERIE									
	Hose I.D. Ø interno tubo			Thread Filetto	Tube	Dimensions (mm)				
	DN	Size	Inch	F	mm	H	L	S		
XFG201304	6	04	1/4"	M20x1,5	13,25	23,8	52,3	24		
XFG201305	8	05	5/16"	M20x1,5	13,25	23,8	52,3	24		
XFG201306	10	06	3/8"	M20x1,5	13,25	23,8	54,3	24		
XFG241706	10	06	3/8"	M24x1,5	16,75	27	57,5	30		
XFG241708	12	08	1/2"	M24x1,5	16,75	27,3	60,3	30		
XFG302108	12	08	1/2"	M30x1,5	21,25	30	63	36		
XFG302110	16	10	5/8"	M30x1,5	21,25	30	66	36		
XFG302112	20	12	3/4"	M30x1,5	21,25	30,6	71,6	36		
XFG362712	20	12	3/4"	M36x1,5	26,75	33,6	74,5	41		
XFG453316	25	16	1"	M45x1,5	33,50	33,9	88,9	50		
XFG453320	32	20	1 1/4"	M45x1,5	33,50	34,5	95,5	50		

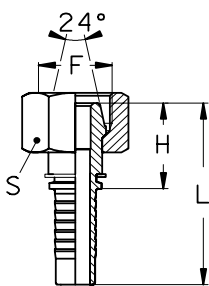

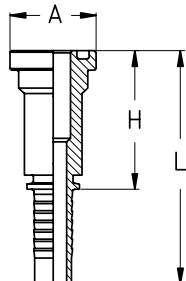

* Straight Komatsu Flange
Flangia Diritta Komatsu

TIEFFE Part. N.	Hose I.D. Ø interno tubo			Flange Flangia	Flange Flangia	Dimensions (mm)				Maximum WP bar
	DN	Size	Inch			H	L	K	A	
X30808B	12	08	1/2"	1/2"		48,5	81,5	30,2		350
X31208B	12	08	1/2"	3/4"		52,5	85,5	38,1		350
* X31008B	12	08	1/2"	5/8"		49,3	82,3	34,0		350
X30810B	16	10	5/8"	1/2"		46,5	82,5	30,2		350
* X31010B	16	10	5/8"	5/8"		49,3	85,3	34,0		350
X31210B	16	10	5/8"	3/4"		52,5	88,5	38,1		350
X30812B	20	12	3/4"	1/2"		36,0	77,0	30,2		350
X31212B	20	12	3/4"	3/4"		53,5	94,5	38,1		350
X31612B	20	12	3/4"	1"		59,5	100,5	44,5		350
X31216B	25	16	1"	3/4"		61,0	116,0	38,1		280
X31616B	25	16	1"	1"		60,5	115,5	44,5		280
X32016B	25	16	1"	1 1/4"		65,0	120,0	50,8		280
X31620B	32	20	1 1/4"	1"		61,0	122,0	44,5		210
X32020B	32	20	1 1/4"	1 1/4"		65,5	126,5	50,8		210
X32420B	32	20	1 1/4"	1 1/2"		70,0	130,0	60,3		210
X32424B	40	24	1 1/2"	1 1/2"		70,5	141,0	60,3		185
X33224B	40	24	1 1/2"	2"		77,5	147,5	71,4		185
X33232B	50	32	2"	2"		77,0	153,0	71,4		170
X34032B	50	32	2"	2 1/2"		77,5	153,5	84,1		170

SFL90

90° SAE J518 FLANGE - 3000 PSI - ONE PIECE FLANGIA 90° SAE J518 - 3000 PSI - INTERA

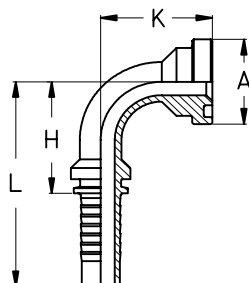

* 90° Komatsu Flange
Flangia 90° Komatsu

TIEFFE Part. N.	Hose I.D. Ø interno tubo			Flange Flangia	Flange Flangia	Dimensions (mm)				Maximum WP bar
	DN	Size	Inch			H	L	K	A	
X3900808B	12	08	1/2"	1/2"		41	74	42	30,2	350
X3901208B	12	08	1/2"	3/4"		41	74	47	38,1	350
* X3901008B	12	08	1/2"	5/8"		41	74	44	34,0	350
X3901008B	16	10	5/8"	1/2"		49	85	46	30,2	350
* X3901010B	16	10	5/8"	5/8"		49	85	49	34,0	350
X3901210B	16	10	5/8"	3/4"		49	85	52	38,1	350
X3900812B	20	12	3/4"	1/2"		58	99	51	30,2	350
X3901212B	20	12	3/4"	3/4"		58	99	57	38,1	350
X3901612B	20	12	3/4"	1"		58	99	62	44,5	350
X3901216B	25	16	1"	3/4"		74	129	69	38,1	280
X3901616B	25	16	1"	1"		74	129	69	44,5	280
X3902016B	25	16	1"	1 1/4"		74	129	70	50,8	280
X3901620B	32	20	1 1/4"	1"		92	153	78	44,5	210
X3902020B	32	20	1 1/4"	1 1/4"		92	153	87	50,8	210
X3902420B	32	20	1 1/4"	1 1/2"		92	153	88	60,3	210
X3902424B	40	24	1 1/2"	1 1/2"		108	179	101	60,3	185
X3903224B	40	24	1 1/2"	2"		108	179	104	71,4	185
X3903232B	50	32	2"	2"		142	218	134	71,4	170
X3904032B	50	32	2"	2 1/2"		142	218	143	84,1	170

TIEFFE Part. N.	STRAIGHT "SUPERCAT" FLANGE - ONE PIECE RECHTE FLENS "SUPERCAT" - UIT 1 STUK									
	Hose I.D. Ø interno tubo			Flange Flangia	Dimensions (mm)					Maximum WP
	DN	Size	Inch	Inch	H	L	A			bar
XC1212	20	12	3/4"	3/4"	65,5	106,0	41,3			350
XC1612	20	12	3/4"	1"	67,5	108,0	47,6			350
XC1616	25	16	1"	1"	71,5	126,0	47,6			280
XC2016	25	16	1"	1 1/4"	74,5	129,5	54,0			280
XC2020	32	20	1 1/4"	1 1/4"	75,0	136,0	54,0			210
XC2420	32	20	1 1/4"	1 1/2"	82,0	143,0	63,5			210
XC2424	40	24	1 1/2"	1 1/2"	83,0	153,0	63,5			185

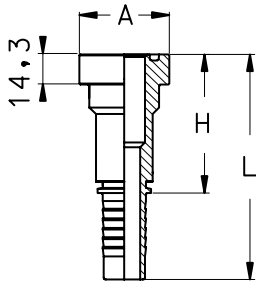

TIEFFE Part. N.	90° "SUPERCAT" FLANGE - ONE PIECE FLENS 90° "SUPERCAT" - UIT 1 STUK									
	Hose I.D. Ø interno tubo			Flange Flangia	Dimensions (mm)					Maximum WP
	DN	Size	Inch	Inch	H	L	K	A		bar
XC901212	20	12	3/4"	3/4"	58	99	67	41,3		350
XC901612	20	12	3/4"	1"	58	99	75	47,6		350
XC901616	25	16	1"	1"	74	129	80	47,6		280
XC902016	25	16	1"	1 1/4"	74	129	86	54,0		280
XC902020	32	20	1 1/4"	1 1/4"	92	153	94	54,0		210
XC902420	32	20	1 1/4"	1 1/2"	92	153	98	63,5		210
XC902424	40	24	1 1/2"	1 1/2"	108	179	103	63,5		185

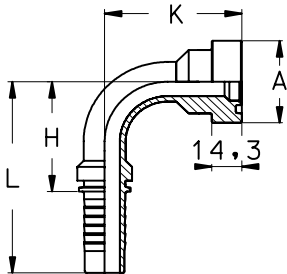

TIEFFE Part. N.	45° "SUPERCAT" FLANGE - ONE PIECE FLENS 45° "SUPERCAT" - UIT 1 STUK									
	Hose I.D. Ø interno tubo			Flange Flangia	Dimensions (mm)					Maximum WP
	DN	Size	Inch	Inch	H	L	K	A		bar
XC451212	20	12	3/4"	3/4"	94,0	135,0	40,0	41,3		350
XC451612	20	12	3/4"	1"	99,0	140,0	45,0	47,6		350
XC451616	25	16	1"	1"	111,5	170,5	47,5	47,6		280
XC452016	25	16	1"	1 1/4"	120,0	175,0	51,5	54		280
XC452020	32	20	1 1/4"	1 1/4"	141,5	202,5	58,0	54		210
XC452420	32	20	1 1/4"	1 1/2"	144,5	205,5	60,5	63,5		210
XC452424	40	24	1 1/2"	1 1/2"	163,5	234,0	60,0	63,5		185

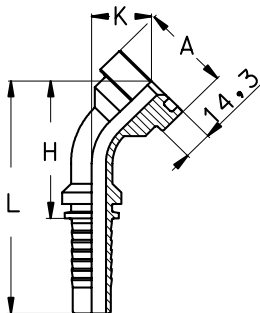

"KOMATSU" METRIC FEMALE - 60° CONE SEAT - CRIMPED NUT METR. WARTELKOPP. "KOMATSU" - CONUS 60° - GEKROMPEN MOER										
TIEFFE Part. N.	Hose I.D. Ø interno tubo			Thread Filetto F	Dimensions (mm)					
	DN	Size	Inch		H	L	S	S1		
XFMJ1404	6	04	1/4"	M14x1,5	24,0	52,5	19	19		
XFMJ1605	8	05	5/16"	M16x1,5	22,2	50,7	22	19		
XFMJ1406	10	06	3/8"	M14x1,5	24,0	54,5	19	19		
XFMJ1606	10	06	3/8"	M16x1,5	22,2	52,7	22	19		
XFMJ1806	10	06	3/8"	M18x1,5	24,3	54,8	24	19		
XFMJ2208	12	08	1/2"	M22x1,5	26,5	59,5	27	27		
XFMJ2408	12	08	1/2"	M24x1,5	29,9	62,9	32	32		
XFMJ2410	16	10	5/8"	M24x1,5	29,9	65,9	32	32		
XFMJ3012	20	12	3/4"	M30x1,5	33,0	74,0	36	36		
XFMJ3316	25	16	1"	M33x1,5	34,5	89,5	41	36		
XFMJ3620	32	20	1 1/4"	M36x1,5	42,6	103,6	46	46		
XFMJ4224	40	24	1 1/2"	M42x1,5	43,5	114,0	50	50		

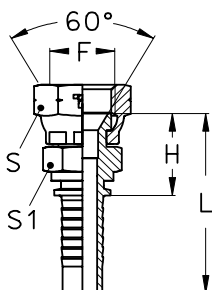

"TOYOTA" B.S.P. FEMALE - 60° CONE SEAT - CRIMPED NUT BSP WARTELKOPP. "TOYOTA" - CONUS 60° - GEKROMPEN MOER										
TIEFFE Part. N.	Hose I.D. Ø interno tubo			Thread Filetto F	Dimensions (mm)					
	DN	Size	Inch		H	L	S	S1		
XBFJ0404	6	04	1/4"	1/4"	21,8	50,3	19	17		
XBFJ0606	10	06	3/8"	3/8"	22,5	53,0	22	19		
XBFJ0808	12	08	1/2"	1/2"	25,2	58,2	27	22		
XBFJ1212	20	12	3/4"	3/4"	29,7	70,7	32	27		
XBFJ1616	25	16	1"	1"	34,3	89,3	41	32		
XBFJ2020	32	20	1 1/4"	1 1/4"	37,0	98,0	50	41		
XBFJ2424	40	24	1 1/2"	1 1/2"	40,2	110,7	55	50		

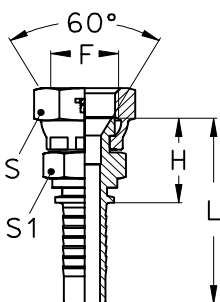

DKOK WASHCLEANER FEMALE - "FK" TYPE CLEANER SLANGKOPPELING - TYPE "FK"										
TIEFFE Part. N.	Hose I.D. Ø interno tubo			Thread Filetto F	Dimensions (mm)					
	DN	Size	Inch		H	L	D			
XKF221404	6	04	1/4"	M22x1,5	36,5	65	14			
XKF221405	8	05	5/16"	M22x1,5	36,5	65	14			
XKF221406	10	06	3/8"	M22x1,5	36,5	67	14			

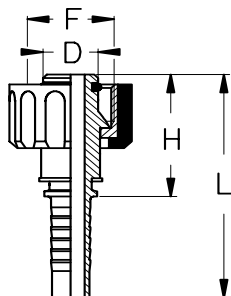

YBM

BSP MALE - PARALLEL - 60° CONE SEAT

BU.DR. SLANGKOPPELING BSP - CONUS 60°

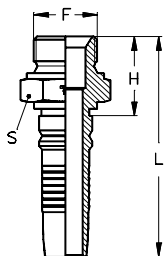

TIEFFE Part.N.	Hose I.D. Ø interno tubo			Thread Filetto	Dimensions (mm)					W. P. (max) bar
	DN	SIZE	Inch		F	H	L	S		
YBM1212	19	12	3/4"	3/4"-14	35	97	32			420
YBM1616	25	16	1"	1"-11	41	114	41			414
YBM2016	25	16	1"	1 1/4"-11	44	117	50			414
YBM2020	31	20	1 1/4"	1 1/4"-11	46	134	50			414
YBM2424	38	24	1 1/2"	1 1/2"-11	49	143	55			345
YBM3232	51	32	2"	2"-11	56	154	70			345

YBT

BSP TAPER MALE - 60° CONE SEAT

BU.DR. SLANGKOPPELING BSP TAPS - CONUS 60°

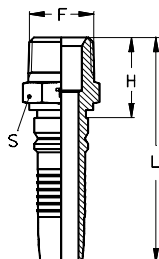

TIEFFE Part.N.	Hose I.D. Ø interno tubo			Thread Filetto	Dimensions (mm)					W. P. (max) bar
	DN	SIZE	Inch		F	H	L	S		
YBT1212	19	12	3/4"	3/4"-14	34	96	27			420
YBT1616	25	16	1"	1"-11	40	113	36			414
YBT2020	31	20	1 1/4"	1 1/4"-11	47	135	46			414
YBT2424	38	24	1 1/2"	1 1/2"-11	48	142	50			345
YBT3232	51	32	2"	2"-11	57	155	65			345

YBF

BSP STRAIGHT FEMALE - 60° O'RING CONE - TIEFFE NUT SLANGKOPP. RECHT BSP - CONUS 60° O'RING - TIEFFE MOER

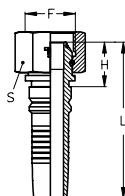

TIEFFE Part.N.	Hose I.D. Ø interno tubo			Thread Filetto F	Dimensions (mm)					W. P. (max) bar
	DN	SIZE	Inch		H	L	S	O'Ring		
YBF1212	19	12	3/4"	3/4"-14	25	87	32	16x1,5	420	
YBF1616	25	16	1"	1"-11	30	103	41	22x1,5	414	
YBF2016	25	16	1"	1 1/4"-11	33	106	50	28,3x1,78	414	
YBF2020	31	20	1 1/4"	1 1/4"-11	35	122	50	28,3x1,78	414	
YBF2424	38	24	1 1/2"	1 1/2"-11	36	130	60	33,05x1,78	345	
YBF3232	51	32	2"	2"-11	40	138	75	44,17x1,78	345	

YBF90

90° BSP SWEPT ELBOW - 60° O'RING CONE - ONE PIECE - TIEFFE NUT SLANGKOPP. 90° BSP - CONUS 60° O'RING - UIT 1 STUK - TIEFFE MOER

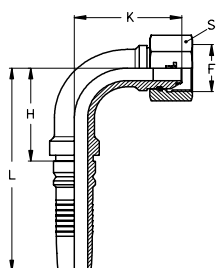

TIEFFE Part.N.	Hose I.D. Ø interno tubo			Thread Filetto F	Dimensions (mm)					W. P. (max) bar
	DN	SIZE	Inch		H	L	K	S	O'Ring	
YBF901212	19	12	3/4"	3/4"-14	55	117	63	32	16x1,5	420
YBF901616	25	16	1"	1"-11	71	144	79	41	22x1,5	414
YBF902016	25	16	1"	1 1/4"-11	71	144	81	50	28,3x1,78	414
YBF902020	31	20	1 1/4"	1 1/4"-11	90	177	96	50	28,3x1,78	414
YBF902424	38	24	1 1/2"	1 1/2"-11	107	201	113	60	33,05x1,78	345
YBF903232	51	32	2"	2"-11	142	240	140	75	44,17x1,78	345

YBF45

45° BSP SWEPT ELBOW - 60° O'RING CONE - ONE PIECE - TIEFFE NUT SLANGKOPP. 45° BSP - CONUS 60° O'RING - UIT 1 STUK - TIEFFE MOER

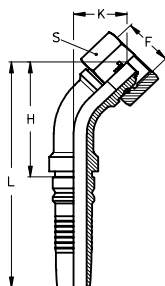

TIEFFE Part.N.	Hose I.D. Ø interno tubo			Thread Filetto F	Dimensions (mm)					W. P. (max) bar
	DN	SIZE	Inch		H	L	K	S	O'Ring	
YBF451212	19	12	3/4"	3/4"-14	68	130	32	32	16x1,5	420
YBF451616	25	16	1"	1"-11	86	159	39	41	22x1,5	414
YBF452016	25	16	1"	1 1/4"-11	88	161	41	50	28,3x1,78	414
YBF452020	31	20	1 1/4"	1 1/4"-11	107	195	47	50	28,3x1,78	414
YBF452424	38	24	1 1/2"	1 1/2"-11	126	220	55	60	33,05x1,78	345
YBF453232	51	32	2"	2"-11	160	258	66	75	44,17x1,78	345

YJM

J.I.C. MALE - 74° CONE BU.DR. SLANGKOPPELING J.I.C. - CONUS 74°

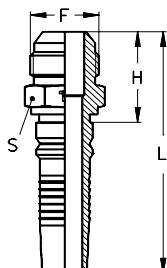

TIEFFE Part.N.	Hose I.D. Ø interno tubo			Thread Filetto	Dimensions (mm)					W. P. (max)
	DN	SIZE	Inch	F	H	L	S			bar
YJM1712	19	12	3/4"	1 1/16"-12	38	99	27			420
YJM1912	19	12	3/4"	1 3/16"-12	39	101	32			420
YJM2112	19	12	3/4"	1 5/16"-12	41	102	36			420
YJM2116	25	16	1"	1 5/16"-12	42	114	36			414
YJM2616	25	16	1"	1 5/8"-12	45	117	46			414
YJM2620	31	20	1 1/4"	1 5/8"-12	47	134	46			414
YJM3020	31	20	1 1/4"	1 7/8"-12	51	139	50			414
YJM3024	38	24	1 1/2"	1 7/8"-12	52	145	50			345
YJM4032	51	32	2"	2 1/2"-12	63	160	65			345

YNM

NPTF MALE - 60° CONE SEAT BU.DR. SLANGKOPP. NPTF - CONUS 60°

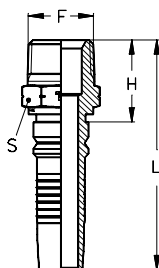

TIEFFE Part.N.	Hose I.D. Ø interno tubo			Thread Filetto	Dimensions (mm)					W. P. (max)
	DN	SIZE	Inch	F	H	L	S			bar
YNM1212	20	12	3/4"	3/4"-14	34	98	27			420
YNM1612	20	12	3/4"	1"-11,5	42	103	36			420
YNM1616	25	16	1"	1"-11,5	42	115	36			420
YNM2016	25	16	1"	1 1/4"-11,5	45	118	46			420
YNM2020	32	20	1 1/4"	1 1/4"-11,5	47	135	46			420
YNM2420	32	20	1 1/4"	1 1/2"-11,5	50	137	50			420
YNM2424	40	24	1 1/2"	1 1/2"-11,5	50	144	50			345
YNM3232	50	32	2"	2"-11,5	55	153	60			345

YJF

J.I.C. STRAIGHT FEMALE - 74° CONE SEAT - TIEFFE NUT SLANGKOPP. WARTEL J.I.C. - CONUS 74° - TIEFFE MOER

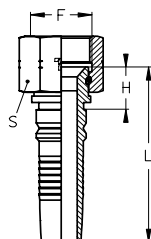

TIEFFE Part.N.	Hose I.D. Ø interno tubo			Thread Filetto F	Dimensions (mm)					W. P. (max) bar
	DN	SIZE	Inch		H	L	S			
YJF1712	19	12	3/4"	1 1/16"-12	20	82		32		420
YJF1912	19	12	3/4"	1 3/16"-12	21,5	83		36		420
YJF2112	19	12	3/4"	1 5/16"-12	22,5	84		41		420
YJF2116	25	16	1"	1 5/16"-12	23,5	96		41		414
YJF2616	25	16	1"	1 5/8"-12	28	101		50		414
YJF2620	31	20	1 1/4"	1 5/8"-12	29	117		50		414
YJF3020	31	20	1 1/4"	1 7/8"-12	29,5	117		60		414
YJF3024	38	24	1 1/2"	1 7/8"-12	30	124		60		345
YJF4032	51	32	2"	2 1/2"-12	37	135		75		345

YJF90

J.I.C. 90° SWEPT ELBOW - 74° CONE SEAT - ONE PIECE - TIEFFE NUT BOCHT 90° J.I.C. - CONUS 74° - UIT 1 STUK - TIEFFE MOER

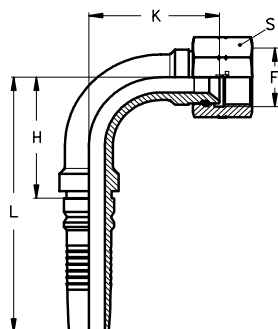

TIEFFE Part.N.	Hose I.D. Ø interno tubo			Thread Filetto F	Dimensions (mm)					W. P. (max) bar
	DN	SIZE	Inch		H	L	K	S		
YJF901712	19	12	3/4"	1 1/16"-12	55	117	58	32		420
YJF901912	19	12	3/4"	1 3/16"-12	55	117	59	36		420
YJF902112	19	12	3/4"	1 5/16"-12	55	117	63	41		420
YJF902116	25	16	1"	1 5/16"-12	71	144	73	41		414
YJF902616	25	16	1"	1 5/8"-12	71	144	76	50		414
YJF902620	31	20	1 1/4"	1 5/8"-12	90	177	91	50		414
YJF903020	31	20	1 1/4"	1 7/8"-12	90	177	91	60		414
YJF903024	38	24	1 1/2"	1 7/8"-12	107	201	106	60		345
YJF904032	51	32	2"	2 1/2"-12	140	240	139	75		345

YJF45

J.I.C. 45° SWEPT ELBOW - 74° CONE SEAT - ONE PIECE - TIEFFE NUT BOCHT 45° J.I.C. - CONUS 74° - UIT 1 STUK - TIEFFE MOER

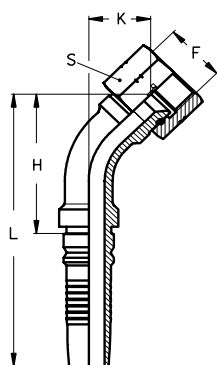

TIEFFE Part.N.	Hose I.D. Ø interno tubo			Thread Filetto F	Dimensions (mm)					W. P. (max) bar
	DN	SIZE	Inch		H	L	K	S		
YJF451712	19	12	3/4"	1 1/16"-12	64	126	28	32		420
YJF451912	19	12	3/4"	1 3/16"-12	65	127	29	36		420
YJF452112	19	12	3/4"	1 5/16"-12	68	130	32	41		420
YJF452116	25	16	1"	1 5/16"-12	82	155	35	41		414
YJF452616	25	16	1"	1 5/8"-12	84	157	37	50		414
YJF452620	31	20	1 1/4"	1 5/8"-12	103	191	43	50		414
YJF453020	31	20	1 1/4"	1 7/8"-12	103	191	43	60		414
YJF453024	38	24	1 1/2"	1 7/8"-12	121	215	50	60		345
YJF454032	51	32	2"	2 1/2"-12	158	256	65	75		345

YMU
ORFS MALE

SLANGKOPPELING BU.DR. ORFS

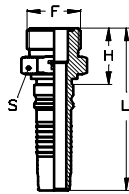

TIEFFE Part.N.	Hose I.D. Ø interno tubo			Thread Filetto	Dimensions (mm)					W. P. (max)
	DN	SIZE	Inch	F	H	L	S	O'Ring**	bar	
YMU1912	19	12	3/4"	1 3/16"-12	34	95	32	18,77x1,78	420	
YMU2116	25	16	1"	1 7/16"-12	37	110	41	23,52x1,78	414	
YMU2720	31	20	1 1/4"	1 11/16"-12	40	128	46	29,87x1,78	250	
YMU3224	38	24	1 1/2"	2"-12	43	136	55	37,82x1,78	250	

YFU
ORFS FEMALE

SLANGKOPP. WARTEL ORFS

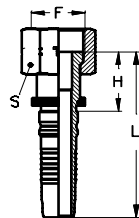

TIEFFE Part.N.	Hose I.D. Ø interno tubo			Thread Filetto	Dimensions (mm)					W. P. (max)
	DN	SIZE	Inch	F	H	L	S	O'Ring**	bar	
YFU1912	19	12	3/4"	1 3/16"-12	35	97	36		420	
YFU2116	25	16	1"	1 7/16"-12	37	110	41		414	
YFU2720	31	20	1 1/4"	1 11/16"-12	38	126	50		250	
YFU3224	38	24	1 1/2"	2"-12	39	132	60		250	

YFU90
90° ORFS SWEPT ELBOW

SLANGKOPP. WARTEL 90° ORFS

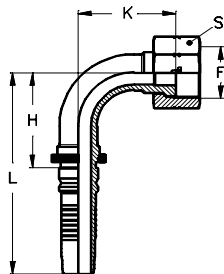

TIEFFE Part.N.	Hose I.D. Ø interno tubo			Thread Filetto	Dimensions (mm)					W. P. (max)
	DN	SIZE	Inch	F	H	L	K	S	bar	
YFU901912	19	12	3/4"	1 3/16"-12	56	118	55	36	420	
YFU902116	25	16	1"	1 7/16"-12	71	144	67	41	414	
YFU902720	31	20	1 1/4"	1 11/16"-12	90	177	81	50	250	
YFU903224	38	24	1 1/2"	2"-12	107	201	95	60	250	

YFU45
45° ORFS SWEPT ELBOW

SLANGKOPP. WARTEL 45° ORFS

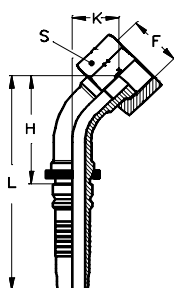

TIEFFE Part.N.	Hose I.D. Ø interno tubo			Thread Filetto	Dimensions (mm)					W. P. (max)
	DN	SIZE	Inch	F	H	L	K	S	bar	
YFU451912	19	12	3/4"	1 3/16"-12	63	125	26	36	420	
YFU452116	25	16	1"	1 7/16"-12	78	151	31	41	414	
YFU452720	31	20	1 1/4"	1 11/16"-12	96	184	36	50	250	
YFU453224	38	24	1 1/2"	2"-12	113	207	42	60	250	

** The "Part.N." do not include O'Ring.

** IL "Part.N." non comprende O'Ring.

YME METRIC MALE - 24° CONE SEAT - HEAVY TYPE SLANGKOPP. BU.DR. METRISCH - CONUS 24° - ZWARE SERIE

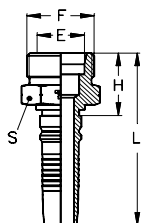

TIEFFE Part.N.	Hose I.D. Ø interno tubo			Thread Filetto	Dimensions (mm)					W. P. (max) bar
	DN	SIZE	Inch		F	H	L	S	E (PIPE)	
YME302012	19	12	3/4"	M 30x2	31	93		30	20	420
YME362512	19	12	3/4"	M 36x2	35	97		36	25	420
YME362516	25	16	1"	M 36x2	36	109		36	25	414
YME423016	25	16	1"	M 42x2	40	113		46	30	280
YME423020	31	20	1 1/4"	M 42x2	42	130		46	30	250
YME523820	31	20	1 1/4"	M 52x2	46	134		55	38	250
YME523824	38	24	1 1/2"	M 52x2	47	141		55	38	250

YFEO O'RING METRIC FEMALE - 24° CONE - HEAVY TYPE SLANGKOPP. WARTEL METRISCH - CONUS 24° O'RING - ZWARE SERIE

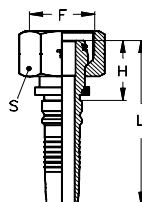

TIEFFE Part.N.	Hose I.D. Ø interno tubo			Thread Filetto	Dimensions (mm)					W. P. (max) bar
	DN	SIZE	Inch		F	H	L	S	O'Ring	
YFEO302012	19	12	3/4"	M 30x2	33	95		36	16,3x2,4	420
YFEO362512	19	12	3/4"	M 36x2	36	98		41	20,3x2,4	420
YFEO362516	25	16	1"	M 36x2	37	110		41	22x2	414
YFEO423016	25	16	1"	M 42x2	39	112		50	25,3x2,4	280
YFEO423020	31	20	1 1/4"	M 42x2	41	128		50	25,3x2,4	250
YFEO523820	31	20	1 1/4"	M 52x2	43	131		60	33,3x2,4	250
YFEO523824	38	24	1 1/2"	M 52x2	44	138		60	33,3x2,4	250

YFEO90 90° METRIC SWEEP ELBOW - 24° CONE - HEAVY TYPE BOCHT 90° METRISCH - CONUS 24° O'RING - ZWARE SERIE

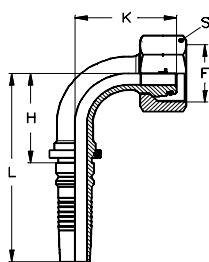

TIEFFE Part.N.	Hose I.D. Ø interno tubo			Thread Filetto	Dimensions (mm)					W. P. (max) bar
	DN	SIZE	Inch		F	H	L	K	S	
YFEO90302012	19	12	3/4"	M 30x2	55	117	60	36	16,3x2,4	420
YFEO90362512	19	12	3/4"	M 36x2	55	117	60	41	20,3x2,4	420
YFEO90362516	25	16	1"	M 36x2	71	144	71	41	22x2	414
YFEO90423016	25	16	1"	M 42x2	71	144	71	50	25,3x2,4	280
YFEO90423020	31	20	1 1/4"	M 42x2	90	177	85	50	25,3x2,4	250
YFEO90523820	31	20	1 1/4"	M 52x2	90	177	86	60	33,3x2,4	250
YFEO90523824	38	24	1 1/2"	M 52x2	107	201	98	60	33,3x2,4	250

YFEO45 45° METRIC SWEEP ELBOW - 24° CONE - HEAVY TYPE BOCHT 45° METRISCH - CONUS 24° O'RING - ZWARE SERIE

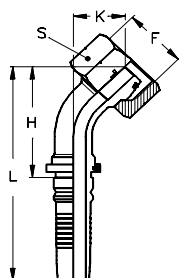

TIEFFE Part.N.	Hose I.D. Ø interno tubo			Thread Filetto	Dimensions (mm)					W. P. (max) bar
	DN	SIZE	Inch		F	H	L	K	S	
YFEO45302012	19	12	3/4"	M 30x2	67	129	29	36	16,3x2,4	420
YFEO45362512	19	12	3/4"	M 36x2	66	128	30	41	20,3x2,4	420
YFEO4536216	25	16	1"	M 36x2	81	154	33	41	22x2	414
YFEO45423016	25	16	1"	M 42x2	81	154	33	50	25,3x2,4	280
YFEO45423020	31	20	1 1/4"	M 42x2	99	187	39	50	25,3x2,4	250
YFEO45523820	31	20	1 1/4"	M 52x2	100	188	40	60	33,3x2,4	250
YFEO45523824	38	24	1 1/2"	M 52x2	116	210	44	60	33,3x2,4	250

Y3

STRAIGHT SAE J518 FLANGE - 3000 PSI - ONE PIECE RECHTE FLENS SAE J518 - 3000 PSI - UIT 1 STUK

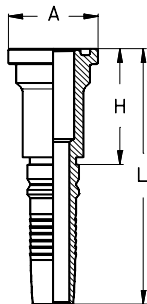

TIEFFE Part.N.	Hose I.D. Ø interno tubo			Flange Flangia	Dimensions (mm)					W. P. (max) bar
	DN	SIZE	Inch		H	L		A	O'Ring**	
Y31212	19	12	3/4"	3/4"	52	113		38	24,99x3,53	350
Y31612	19	12	3/4"	1"	58	119		44,5	32,92x3,53	350
Y31612	25	16	1"	3/4"	53	125		38	24,99x3,53	350
Y31616	25	16	1"	1"	59	131		44,5	32,92x3,53	350
Y32016	25	16	1"	1 1/4"	63	135		51	37,69x3,53	250
Y32020	31	20	1 1/4"	1 1/4"	64	151		51	37,69x3,53	250
Y32420	31	20	1 1/4"	1 1/2"	69	156		60,5	47,22x3,53	200
Y32424	38	24	1 1/2"	1 1/2"	69	163		60,5	47,22x3,53	200
Y33224	38	24	1 1/2"	2"	74	168		71,5	56,74x3,53	200
Y33232	51	32	2"	2"	76	173		71,5	56,74x3,53	200

Y390

90° SWEPT ELBOW - SAE J518 FLANGE - 3000 PSI - ONE PIECE BOCHT 90° - FLENS SAE J518 - 3000 PSI - UIT 1 STUK

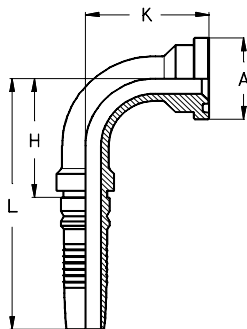

TIEFFE Part.N.	Hose I.D. Ø interno tubo			Flange Flangia	Dimensions (mm)					W. P. (max) bar
	DN	SIZE	Inch		H	L	K	A	O'Ring**	
Y3901212	19	12	3/4"	3/4"	56	118	56	38	24,99x3,53	350
Y3901612	19	12	3/4"	1"	56	118	61	44,5	32,92x3,53	350
Y3901216	25	16	1"	3/4"	72	145	67	38	24,99x3,53	350
Y3901616	25	16	1"	1"	72	145	68	44,5	32,92x3,53	350
Y3902016	25	16	1"	1 1/4"	72	145	70	51	37,69x3,53	250
Y3902020	31	20	1 1/4"	1 1/4"	91	178	85	51	37,69x3,53	250
Y3902420	31	20	1 1/4"	1 1/2"	91	178	85	60,5	47,22x3,53	200
Y3902424	38	24	1 1/2"	1 1/2"	108	202	100	60,5	47,22x3,53	200
Y3903224	38	24	1 1/2"	2"	108	202	102	71,5	56,74x3,53	200
Y3903232	51	32	2"	2"	143	281	129	71,5	56,74x3,53	200

Y345

45° SWEPT ELBOW - SAE J518 FLANGE - 3000 PSI - ONE PIECE BOCHT 45° - FLENS SAE J518 - 3000 PSI - UIT 1 STUK

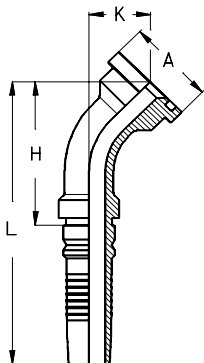

TIEFFE Part.N.	Hose I.D. Ø interno tubo			Flange Flangia	Dimensions (mm)					W. P. (max) bar
	DN	SIZE	Inch		H	L	K	A	O'Ring**	
Y3451212	19	12	3/4"	3/4"	63	125	27	38	24,99x3,53	350
Y3451612	19	12	3/4"	1"	67	129	31	44,5	32,92x3,53	350
Y3451216	25	16	1"	3/4"	78	151	31	38	24,99x3,53	350
Y3451616	25	16	1"	1"	79	152	32	44,5	32,92x3,53	350
Y3452016	25	16	1"	1 1/4"	80	153	33	51	37,69x3,53	250
Y3452020	31	20	1 1/4"	1 1/4"	99	187	39	51	37,69x3,53	250
Y3452420	31	20	1 1/4"	1 1/2"	99	187	39	60,5	47,22x3,53	200
Y3452424	38	24	1 1/2"	1 1/2"	117	211	46	60,5	47,22x3,53	200
Y3453224	38	24	1 1/2"	2"	118	212	47	71,5	56,74x3,53	200
Y3453232	51	32	2"	2"	152	250	58	71,5	56,74x3,53	200

** The "Part.N." do not include O'Ring.

** IL "Part.N." non comprende O'Ring.

Y6

STRAIGHT SAE J518 FLANGE - 6000 PSI - ONE PIECE RECHTE FLENS SAE J518 - 6000 PSI - UIT 1 STUK

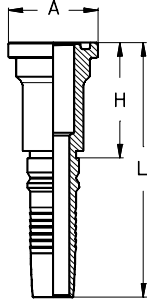

TIEFFE Part.N.	Hose I.D. Ø interno tubo			Flange Flangia	Dimensions (mm)					W. P. (max) bar
	DN	SIZE	Inch		H	L	A	O'Ring**		
Y61212	19	12	3/4"	3/4"	58	120	41,3	24,99x3,53	420	
Y61612	19	12	3/4"	1"	60	122	47,6	32,92x3,53	420	
Y61216	25	16	1"	3/4"	59	132	41,3	24,99x3,53	415	
Y61616	25	16	1"	1"	64	137	47,6	32,92x3,53	415	
Y62016	25	16	1"	1 1/4"	68	141	54	37,69x3,53	415	
Y62020	31	20	1 1/4"	1 1/4"	69	157	54	37,69x3,53	415	
Y62420	31	20	1 1/4"	1 1/2"	79	166	63,5	47,22x3,53	415	
Y62424	38	24	1 1/2"	1 1/2"	79	173	63,5	47,22x3,53	345	
Y63232	51	32	2"	2"	97	195	79,4	56,74x3,53	345	

Y690

90° SWEPT ELBOW - SAE J518 FLANGE - 6000 PSI - ONE PIECE BOCHT 90° - FLENS SAE J518 - 6000 PSI - UIT 1 STUK

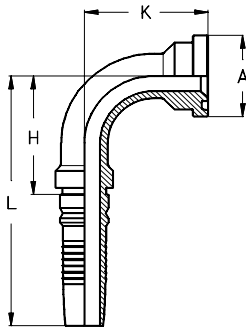

TIEFFE Part.N.	Hose I.D. Ø interno tubo			Flange Flangia	Dimensions (mm)					W. P. (max) bar
	DN	SIZE	Inch		H	L	K	A	O'Ring**	
Y6901212	19	12	3/4"	3/4"	56	118	61	41,3	24,99x3,53	420
Y6901612	19	12	3/4"	1"	56	118	66	47,6	32,92x3,53	420
Y6901216	25	16	1"	3/4"	72	145	67	41,3	24,99x3,53	415
Y6901616	25	16	1"	1"	72	145	72	47,6	32,92x3,53	415
Y6902016	25	16	1"	1 1/4"	72	145	79	54	37,69x3,53	415
Y6902020	31	20	1 1/4"	1 1/4"	91	178	86	54	37,69x3,53	415
Y6902420	31	20	1 1/4"	1 1/2"	91	178	93	63,5	47,22x3,53	415
Y6902424	38	24	1 1/2"	1 1/2"	108	202	100	63,5	47,22x3,53	345
Y6903232	51	32	2"	2"	143	240	131	79,4	56,74x3,53	345

Y645

45° SWEPT ELBOW - SAE J518 FLANGE - 6000 PSI - ONE PIECE BOCHT 45° FLENS SAE J518 - 6000 PSI - UIT 1 STUK

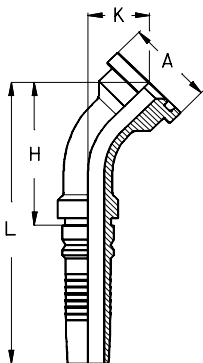

TIEFFE Part.N.	Hose I.D. Ø interno tubo			Flange Flangia	Dimensions (mm)					W. P. (max) bar
	DN	SIZE	Inch		H	L	K	A	O'Ring**	
Y6451212	19	12	3/4"	3/4"	67	129	31	41,3	24,99x3,53	420
Y6451612	19	12	3/4"	1"	71	132	34	47,6	32,92x3,53	420
Y6451216	25	16	1"	3/4"	78	151	31	41,3	24,99x3,53	415
Y6451616	25	16	1"	1"	82	155	35	47,6	32,92x3,53	415
Y6452016	25	16	1"	1 1/4"	87	160	40	54	37,69x3,53	415
Y6452020	31	20	1 1/4"	1 1/4"	100	188	40	54	37,69x3,53	415
Y6452420	31	20	1 1/4"	1 1/2"	105	193	45	63,5	47,22x3,53	415
Y6452424	38	24	1 1/2"	1 1/2"	117	211	46	63,5	47,22x3,53	345
Y6453232	51	32	2"	2"	154	252	60	79,4	56,74x3,53	345

** The "Part.N." do not include O'Ring.

** IL "Part.N." non comprende O'Ring.

YC

STRAIGHT "SUPERCAT" FLANGE - ONE PIECE

RECHTE FLENS "SUPERCAT" - UIT 1 STUK

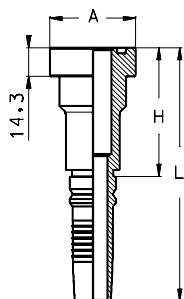

TIEFFE Part.N.	Hose I.D. Ø interno tubo			Flange Flangia	Dimensions (mm)					W. P. (max) bar
	DN	SIZE	Inch		H	L	A	O'Ring**		
YC1212	19	12	3/4"	3/4"	64	126	41,3	24,99x3,53	420	
YC1612	19	12	3/4"	1"	65	127	47,6	32,92x3,53	420	
YC1616	25	16	1"	1"	69	142	47,6	32,92x3,53	415	
YC2016	25	16	1"	1 1/4"	72	145	54	37,69x3,53	415	
YC2020	31	20	1 1/4"	1 1/4"	73	161	54	37,69x3,53	415	
YC2420	31	20	1 1/4"	1 1/2"	80	168	63,5	47,22x3,53	415	
YC2424	38	24	1 1/2"	1 1/2"	81	175	63,5	47,22x3,53	345	

YC90

90° "SUPERCAT" FLANGE - ONE PIECE

FLENS 90° "SUPERCAT" - UIT 1 STUK

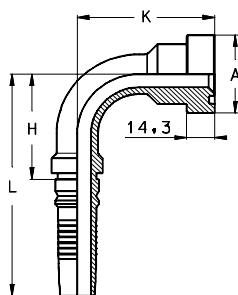

TIEFFE Part.N.	Hose I.D. Ø interno tubo			Flange Flangia	Dimensions (mm)					W. P. (max) bar
	DN	SIZE	Inch		H	L	K	A	O'Ring**	
YC901212	19	12	3/4"	3/4"	55	117	70	41,3	24,99x3,53	420
YC901612	19	12	3/4"	1"	55	117	73	47,6	32,92x3,53	420
YC901616	25	16	1"	1"	71	144	79	47,6	32,92x3,53	415
YC902016	25	16	1"	1 1/4"	71	144	82	54	37,69x3,53	415
YC902020	31	20	1 1/4"	1 1/4"	90	177	89	54	37,69x3,53	415
YC902420	31	20	1 1/4"	1 1/2"	90	177	97	63,5	47,22x3,53	415
YC902424	38	24	1 1/2"	1 1/2"	107	201	105	63,5	47,22x3,53	345

YC45

45° "SUPERCAT" FLANGE - ONE PIECE

FLENS 45° "SUPERCAT" - UIT 1 STUK

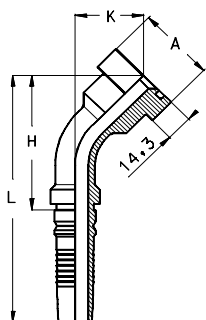

TIEFFE Part.N.	Hose I.D. Ø interno tubo			Flange Flangia	Dimensions (mm)					W. P. (max) bar
	DN	SIZE	Inch		H	L	K	A	O'Ring**	
YC451212	19	12	3/4"	3/4"	73	135	37	41,3	24,99x3,53	420
YC451612	19	12	3/4"	1"	76	137	39	47,6	32,92x3,53	420
YC451616	25	16	1"	1"	87	160	40	47,6	32,92x3,53	415
YC452016	25	16	1"	1 1/4"	88	161	41	54	37,69x3,53	415
YC452020	31	20	1 1/4"	1 1/4"	102	189	42	54	37,69x3,53	415
YC452420	31	20	1 1/4"	1 1/2"	108	196	48	63,5	47,22x3,53	415
YC452424	38	24	1 1/2"	1 1/2"	120	214	49	63,5	47,22x3,53	345

** The "Part.N." do not include O'Ring.

** Het "artikel no" is zonder O'Ring.

NIET SCHILLEN

HSN4

NON SKIVE SWAGED FERRULE HULS NIET SCHILLEN

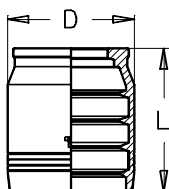

TIEFFE Part. N°	Hose I.D. Ø Interno tuHo			Dimensions (mm)		Applications Applicazioni					
	DN	SIZE	Inch	D	L						
HSN412	19	12	3/4"	43	50	4SP	4SH	R9R	R12	R13	R15
HSN416	25	16	1"	51	56	4SP	4SH	R9R	R12	R13	R15
HSN420	31	20	1 1/4"	61	68		4SH	R9R	R12		
HSN424	38	24	1 1/2"	70	86		4SH	R9R	R12		
HSN432	51	32	2"	85	100		4SH	R9R	R12		

SCHILLEN

HSS4

OUTSIDE SKIVE SWAGED FERRULE HULS VOOR ALLEEN BUITEN SCHILLEN

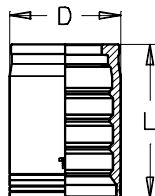

TIEFFE Part. N°	Hose I.D. Ø Interno tuHo			Dimensions (mm)		Applications Applicazioni					
	DN	SIZE	Inch	D	L						
HSS412	19	12	3/4"	38	54	4SP	4SH	R9R	R12	R13	R15
HSS416	25	16	1"	46	60	4SP	4SH	R9R	R12	R13	R15
HSS420	31	20	1 1/4"	54	72		4SH	R9R	R12		
HSS424	38	24	1 1/2"	62	90		4SH	R9R	R12		
HSS432	51	32	2"	76	102		4SH	R9R	R12		

SCHILLEN

HSS6

OUTSIDE SKIVE SWAGED FERRULE HULS VOOR BUITENSCHILLEN

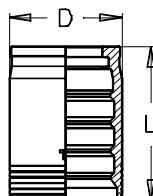

TIEFFE Part. N°	Hose I.D. Ø Interno tuHo			Dimensions (mm)		Applications Applicazioni					
	DN	SIZE	Inch	D	L						
HSS620	31	20	1 1/4"	58	72	4SP				R13	R15
HSS624	38	24	1 1/2"	68	90	4SP				R13	R15
HSS632	51	32	2"	84	102	4SP				R13	

BS 5200

DKOR

BSP STRAIGHT FEMALE - 60° O-RING CONE - TIEFFE NUT WARTELKOPP. BSP (GAS) - CONUS 60° O-RING - TIEFFE MOER

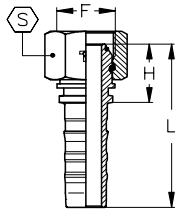

TIEFFE Part.N.	Hose I.D. Ø interno tubo			Thread Filettatura F	Dimensions (mm)				Maximum W.P.	
	DN	Size	Inch		H	L	S	O'Ring	bar	PSI
ZBF1212	20	12	3/4"	3/4"-14	29	80	32	17x1,5	420	6000
ZBF1612	20	12	3/4"	1"-11	32	83	41	22x1,5	420	6000
ZBF1616	25	16	1"	1"-11	34	90	41	22x1,5	420	6000
ZBF2016	25	16	1"	1 1/4"-11	37	93	50	28,3x1,78	345	5000
ZBF2020	32	20	1 1/4"	1 1/4"-11	39	106	50	28,3x1,78	345	5000
ZBF2420	32	20	1 1/4"	1 1/2"-11	41	107	60	33,05x1,78	345	5000
ZBF2424	40	24	1 1/2"	1 1/2"-11	43	125	60	33,05x1,78	345	5000
ZBF3232	50	32	2"	2"-11	47	143	75	44,17x1,78	345	5000

BS 5200

DKOR45

45° BSP SWEPT ELBOW - 60° O-RING CONE - TIEFFE NUT BOCHT 45° BSP (GAS) - CONUS 60° O-RING - TIEFFE MOER

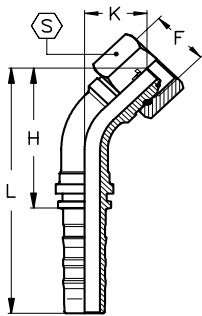

TIEFFE Part.N.	Hose I.D. Ø interno tubo			Thread Filettatura F	Dimensions (mm)				Maximum W.P.		
	DN	Size	Inch		H	L	K	S	O'Ring	bar	PSI
ZBF451212	20	12	3/4"	3/4"-14	67	118	29	32	17x1,5	420	6000
ZBF451612	20	12	3/4"	1"-11	67	118	29	41	22x1,5	420	6000
ZBF451616	25	16	1"	1"-11	86	142	36	41	22x1,5	420	6000
ZBF452016	25	16	1"	1 1/4"-11	86	142	36	50	28,3x1,78	345	5000
ZBF452020	32	20	1 1/4"	1 1/4"-11	103	169	43	50	28,3x1,78	345	5000
ZBF452420	32	20	1 1/4"	1 1/2"-11	103	169	43	60	33,05x1,78	345	5000
ZBF452424	40	24	1 1/2"	1 1/2"-11	123	206	51	60	33,05x1,78	345	5000
ZBF453232	50	32	2"	2"-11	160	257	65	75	44,17x1,78	345	5000

BS 5200

DKOR90

90° BSP SWEPT ELBOW - 60° O-RING CONE - TIEFFE NUT BOCHT 90° BSP (GAS) - CONUS 60° O-RING - TIEFFE MOER

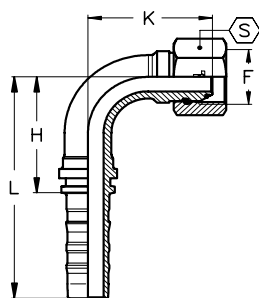

TIEFFE Part.N.	Hose I.D. Ø interno tubo			Thread Filettatura F	Dimensions (mm)				Maximum W.P.		
	DN	Size	Inch		H	L	K	S	O'Ring	bar	PSI
ZBF901212	20	12	3/4"	3/4"-14	55	106	57	32	17x1,5	420	6000
ZBF901612	20	12	3/4"	1"-11	55	106	57	41	22x1,5	420	6000
ZBF901616	25	16	1"	1"-11	71	128	72	41	22x1,5	420	6000
ZBF902016	25	16	1"	1 1/4"-11	71	128	72	50	28,3x1,78	345	5000
ZBF902020	32	20	1 1/4"	1 1/4"-11	87	154	88	50	28,3x1,78	345	5000
ZBF902420	32	20	1 1/4"	1 1/2"-11	87	154	88	60	33,05x1,78	345	5000
ZBF902424	40	24	1 1/2"	1 1/2"-11	105	188	104	60	33,05x1,78	345	5000
ZBF903232	50	32	2"	2"-11	140	237	137	75	44,17x1,78	345	5000

SAE J516		AGN		N.P.T.F. MALE - 60° CONE SEAT NPTF MALE KOPPELING - CONUS 60°							
TIEFFE Part.N.	Hose I.D. Ø interno tubo			Thread Filetto	Dimensions (mm)					Maximum W.P.	
	DN	Size	Inch	F	H	L	S			bar	PSI
ZNM1212	20	12	3/4"	3/4"-14	39	90	27			420	6000
ZNM1612	20	12	3/4"	1"-11,5	47	98	36			380	5400
ZNM1216	20	12	3/4"	3/4"-14	41,5	98	32			420	6000
ZNM1616	20	12	3/4"	1"-11,5	48,5	105	36			380	5400
ZNM2016	20	12	3/4"	1 1/4"-11,5	53	109,5	46			325	4600
ZNM1620	32	20	1 1/4"	1"-11,5	52,5	119	41			380	5400
ZNM2020	32	20	1 1/4"	1 1/4"-11,5	55	121,5	46			325	4600
ZNM2420	32	20	1 1/4"	1 1/2"-11,5	59	125,5	50			290	4100
ZNM2424	38	24	1 1/2"	1 1/2"-11,5	61	143,5	50			290	4100
ZNM3224	38	24	1 1/2"	2"-11,5	67,5	150	65			250	3600
ZNM3232	51	32	2"	2"-11,5	70,5	167	65			250	3600

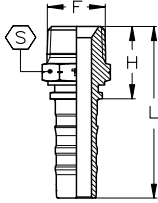

ISO12151/5 SAE J516		AGJ		J.I.C. MALE - 74° CONE JIC MALE KOPPELING - CONUS 74°							
TIEFFE Part.N.	Hose I.D. Ø interno tubo			Thread Filetto	Dimensions (mm)					Maximum W.P.	
	DN	Size	Inch	F	H	L	S			bar	PSI
ZJM1412	20	12	3/4"	7/8"-14	37	88	27			420	6000
ZJM1712	20	12	3/4"	1 1/16"-12	40	91	27			420	6000
ZJM1912	20	12	3/4"	1 3/16"-12	41,5	92,5	32			420	6000
ZJM2112	20	12	3/4"	1 5/16"-12	43	94	36			380	5400
ZJM1716	25	16	1"	1 1/16"-12	43	99,5	32			420	6000
ZJM2116	25	16	1"	1 5/16"-12	45	101,5	36			380	5400
ZJM2616	25	16	1"	1 5/8"-12	48	104,5	46			325	4600
ZJM2120	32	20	1 1/4"	1 5/16"-12	48,5	115	41			380	5400
ZJM2620	32	20	1 1/4"	1 5/8"-12	50,5	117	46			325	4600
ZJM3020	32	20	1 1/4"	1 7/8"-12	55	121,5	50			290	4100
ZJM3024	38	24	1 1/2"	1 7/8"-12	57	139,5	50			290	4100
ZJM4024	38	24	1 1/2"	2 1/2"-12	65,5	148	65			250	3600
ZJM4032	51	32	2"	2 1/2"-12	68,5	165	65			250	3600

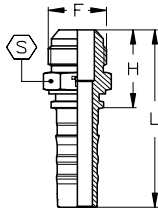

ISO12151/5 SAE J516		DKJ		J.I.C. FEMALE - 74° CONE SEAT - DOUBLE EXAGON - TIEFFE NUT JIC WARTELKOPPELING MET ZESKANT - CONUS 74° - TIEFFE MOER							
TIEFFE Part.N.	Hose I.D. Ø interno tubo			Thread Filetto	Dimensions (mm)					Maximum W.P.	
	DN	Size	Inch	F	H	L	S	S1		bar	PSI
ZJF1412	20	12	3/4"	7/8"-14	33	84	27	27		420	6000
ZJF1712	20	12	3/4"	1 1/16"-12	34	85	32	27		420	6000
ZJF1912	20	12	3/4"	1 3/16"-12	35,5	86,5	36	30		420	6000
ZJF2112	20	12	3/4"	1 5/16"-12	38	89	41	32		380	5400
ZJF1716	25	16	1"	1 1/16"-12	36,5	93	32	32		420	6000
ZJF2116	25	16	1"	1 5/16"-12	39,5	96	41	32		380	5400
ZJF2616	25	16	1"	1 5/8"-12	46	102,5	50	41		325	4600
ZJF2120	32	20	1 1/4"	1 5/16"-12	45,5	112	41	41		380	5400
ZJF2620	32	20	1 1/4"	1 5/8"-12	48	114,5	50	41		325	4600
ZJF3020	32	20	1 1/4"	1 7/8"-12	51	117,5	60	46		290	4100
ZJF3024	38	24	1 1/2"	1 7/8"-12	53	135,5	60	46		290	4100
ZJF4024	38	24	1 1/2"	2 1/2"-12	66	148,5	75	60		250	3600
ZJF4032	51	32	2"	2 1/2"-12	69	165,5	75	60		250	3600

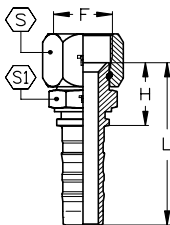

**ISO12151/5
SAE J516**

DKJ45

JIC 45° SWEPT ELBOW - 74° CONE SEAT - TIEFFE NUT
JIC WARTEL MET BOCHT 45° JIC - CONUS 74° - TIEFFE MOER

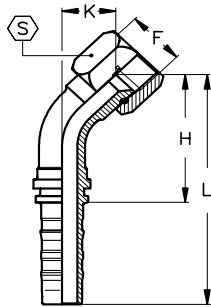

TIEFFE Part.N.	Hose I.D. Ø interno tubo			Thread Filetto	Dimensions (mm)					Maximum W.P.	
	DN	Size	Inch	F	H	L	K	S	bar	PSI	
ZJF451412	20	12	3/4"	7/8"-14	66	117	28	27		420	6000
ZJF451712	20	12	3/4"	1 1/16"-12	63	114	25	32		420	6000
ZJF451912	20	12	3/4"	1 3/16"-12	63	114	25	36		420	6000
ZJF452112	20	12	3/4"	1 5/16"-12	63	114	25	41		380	5400
ZJF451716	25	16	1"	1 1/16"-12	85	141	35	32		420	6000
ZJF452116	25	16	1"	1 5/16"-12	82	138	32	41		380	5400
ZJF452616	25	16	1"	1 5/8"-12	82	138	32	50		325	4600
ZJF452120	32	20	1 1/4"	1 5/16"-12	100	167	41	41		380	5400
ZJF452620	32	20	1 1/4"	1 5/8"-12	98	164	38	50		325	4600
ZJF453020	32	20	1 1/4"	1 7/8"-12	98	164	38	60		290	4100
ZJF453024	38	24	1 1/2"	1 7/8"-12	118	201	46	60		290	4100
ZJF454024	38	24	1 1/2"	2 1/2"-12	118	201	46	75		250	3600
ZJF454032	51	32	2"	2 1/2"-12	157	253	62	75		250	3600

**ISO12151/5
SAE J516**

DKJ90

JIC 90° SWEPT ELBOW - 74° CONE SEAT - TIEFFE NUT
JIC WARTEL MET BOCHT 90° - CONUS 74° - TIEFFE MOER

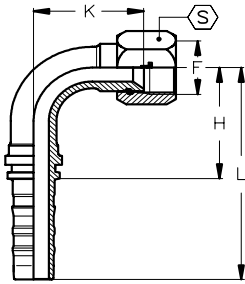

TIEFFE Part.N.	Hose I.D. Ø interno tubo			Thread Filetto	Dimensions (mm)					Maximum W.P.	
	DN	Size	Inch	F	H	L	K	S	bar	PSI	
ZJF901412	20	12	3/4"	7/8"-14	55	106	55	27		420	6000
ZJF901712	20	12	3/4"	1 1/16"-12	55	106	52	32		420	6000
ZJF901912	20	12	3/4"	1 3/16"-12	55	106	52	36		420	6000
ZJF902112	20	12	3/4"	1 5/16"-12	55	106	52	41		380	5400
ZJF901716	25	16	1"	1 1/16"-12	71	128	71	32		420	6000
ZJF902116	25	16	1"	1 5/16"-12	71	128	67	41		380	5400
ZJF902616	25	16	1"	1 5/8"-12	71	128	67	50		325	4600
ZJF902120	32	20	1 1/4"	1 5/16"-12	87	154	84	41		380	5400
ZJF902620	32	20	1 1/4"	1 5/8"-12	87	154	81	50		325	4600
ZJF903020	32	20	1 1/4"	1 7/8"-12	87	154	81	60		290	4100
ZJF903024	38	24	1 1/2"	1 7/8"-12	105	188	97	60		290	4100
ZJF904024	38	24	1 1/2"	2 1/2"-12	105	188	97	75		250	3500
ZJF904032	51	32	2"	2 1/2"-12	140	237	132	75		250	3500

**ISO12151/5
SAE J516**

DKJ90

LANGE BOCHT

JIC 90° LONG DROP SWEPT ELBOW - 74° CONE SEAT - TIEFFE NUT
JIC WARTEL MET BOCHT 90° - CONUS 74° - TIEFFE MOER

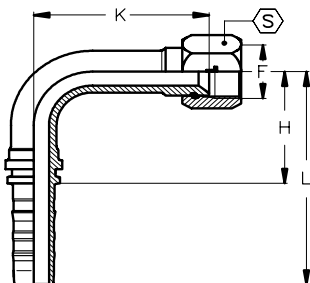

TIEFFE Part.N.	Hose I.D. Ø interno tubo			Thread Filetto	Dimensions (mm)					Maximum W.P.	
	DN	Size	Inch	F	H	L	K	S	bar	PSI	
ZJF901712-K96	20	12	3/4"	1 1/16"-12	55	106	96	32		420	6000
ZJF902116-K116	25	16	1"	1 5/16"-12	71	128	116	41		380	5400
ZJF902616-K116	25	16	1"	1 5/8"-12	71	128	116	50		325	4600
ZJF902620-K136	32	20	1 1/4"	1 5/8"-12	87	154	136	50		325	4600
ZJF903024-K162	38	24	1 1/2"	1 7/8"-12	105	188	162	60		290	4100
ZJF904032-K220	51	32	2"	2 1/2"-12	140	137	220	75		250	3500

ISO 12151-2
DIN 20078

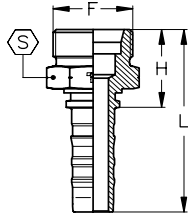

CES

METRIC MALE - 24° CONE SEAT - HEAVY DUTY
BUITENDRAAD METRISCH - CONUS 24° - ZWARE SERIE

TIEFFE Part.N.	Hose I.D. Ø interno tubo			Thread Filettatura	Tube	Dimensions (mm)					Maximum W.P.	
	DN	Size	Inch	F	mm	H	L	S			bar	PSI
ZME302012	20	12	3/4"	M30x2	20	34	85	30			420	6000
ZME362512	20	12	3/4"	M36x2	25	38	89	36			420	6000
ZME362516	25	16	1"	M36x2	25	40	97	36			380	5400
ZME423016	25	16	1"	M42x2	30	44	101	46			280	4000
ZME423020	32	20	1 1/4"	M42x2	30	47	113	46			250	3500
ZME523820	32	20	1 1/4"	M52x2	38	51	117	55			250	3500
ZME523824	40	24	1 1/2"	M52x2	38	53	135	55			250	3500

ISO 12151-2
DIN 20078

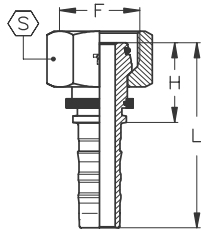

DKOS

METRIC FEMALE - 24° O'RING CONE - HEAVY DUTY
WARELKOPPELING METRISCH - CONUS 24° O'RING - ZWARE SERIE

TIEFFE Part.N.	Hose I.D. Ø interno tubo			Thread Filettatura	Tube	Dimensions (mm)					Maximum W.P.	
	DN	Size	Inch	F	mm	H	L	S	O'Ring	bar	PSI	
ZFEO302012	20	12	3/4"	M30x2	20	37	88	36	16,3x2,4	420	6000	
ZFEO362512	20	12	3/4"	M36x2	25	39	90	46	20,3x2,4	420	6000	
ZFEO362516	25	16	1"	M36x2	25	41	97	46	22x2	380	5400	
ZFEO423016	25	16	1"	M42x2	30	42	98	50	25,3x2,4	280	4000	
ZFEO423020	32	20	1 1/4"	M42x2	30	43	109	50	25,3x2,4	250	3500	
ZFEO523820	32	20	1 1/4"	M52x2	38	48	115	60	33,3x2,4	250	3500	
ZFEO523824	40	24	1 1/2"	M52x2	38	51	133	60	33,3x2,4	250	3500	

ISO 12151-2
DIN 20078

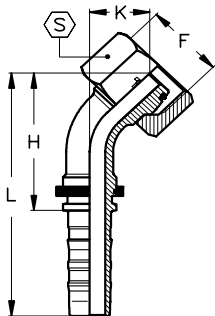

DKOS45

45° METRIC SWEPT ELBOW - 24° O'RING CONE - HEAVY DUTY
BOCHT 45° METRISCH - CONUS 24° O'RING - ZWARE SERIE

TIEFFE Part.N.	Hose I.D. Ø interno tubo			Thread Filettatura	Tube	Dimensions (mm)					Maximum W.P.	
	DN	Size	Inch	F	mm	H	L	K	S	O'Ring	bar	PSI
ZFEO45302012	20	12	3/4"	M30x2	20	65	116	27	36	16,3x2,4	420	6000
ZFEO45362512	20	12	3/4"	M36x2	25	66	117	28	46	20,3x2,4	420	6000
ZFEO45362516	25	16	1"	M36x2	25	83	140	34	46	22x2	380	5400
ZFEO45423016	25	16	1"	M42x2	30	82	138	32	50	25,3x2,4	280	4000
ZFEO45423020	32	20	1 1/4"	M42x2	30	100	166	40	50	25,3x2,4	250	3500
ZFEO45523820	32	20	1 1/4"	M52x2	38	97	164	38	60	33,3x2,4	250	3500
ZFEO45523824	40	24	1 1/2"	M52x2	38	121	203	48	60	33,3x2,4	250	3500

ISO 12151-2
DIN 20078

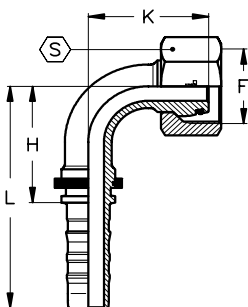

DKOS90

90° METRIC SWEPT ELBOW - 24° O'RING CONE - HEAVY DUTY
BOCHT 90° METRISCH - CONUS 24° O'RING - ZWARE SERIE

TIEFFE Part.N.	Hose I.D. Ø interno tubo			Thread Filettatura	Tube	Dimensions (mm)					Maximum W.P.	
	DN	Size	Inch	F	mm	H	L	K	S	O'Ring	bar	PSI
ZFEO90302012	20	12	3/4"	M30x2	20	55	106	55	36	16,3x2,4	420	6000
ZFEO90362512	20	12	3/4"	M36x2	25	55	106	55	46	20,3x2,4	420	6000
ZFEO90362516	25	16	1"	M36x2	25	71	128	69	46	22x2	380	5400
ZFEO90423016	25	16	1"	M42x2	30	71	128	67	50	25,3x2,4	280	4000
ZFEO90423020	32	20	1 1/4"	M42x2	30	87	154	83	50	25,3x2,4	250	3500
ZFEO90523820	32	20	1 1/4"	M52x2	38	87	154	80	60	33,3x2,4	250	3500
ZFEO90523824	40	24	1 1/2"	M52x2	38	105	188	100	60	33,3x2,4	250	3500

ISO12151/3
SAE J516

SFL

STRAIGHT FLANGE - ISO "L" SERIES - SAE CODE 61
RECHTE FLENS - ISO SERIE "L" - SAE CODE 61

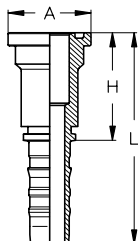

TIEFFE Part.N.	Hose I.D. Ø interno tubo			Flange Flangia		Dimensions (mm)				Maximum W.P.	
	DN	Size	Inch	Size	Inch	H	L	A		bar	PSI
Z31212	20	12	3/4"	12	3/4"	55	106	38,1		350	5000
Z31612	20	12	3/4"	16	1"	57	108	44,5		350	5000
Z32012	20	12	3/4"	20	1 1/4"	55	106	50,8		280	4000
Z31216	25	16	1"	12	3/4"	58	114,5	38,1		350	5000
Z31616	25	16	1"	16	1"	58	114,5	44,5		350	5000
Z32016	25	16	1"	20	1 1/4"	63	119,5	50,8		280	4000
Z32416	25	16	1"	24	1 1/2"	55	115,5	60,4		210	3000
Z31620	32	20	1 1/4"	16	1"	64	130,5	44,5		350	5000
Z32020	32	20	1 1/4"	20	1 1/4"	64	130,5	50,8		280	4000
Z32420	32	20	1 1/4"	24	1 1/2"	68	134,5	60,4		210	3000
Z33220	32	20	1 1/4"	32	2"	75	141,5	71,4		210	3000
Z32424	38	24	1 1/2"	24	1 1/2"	73	155,5	60,4		210	3000
Z33224	38	24	1 1/2"	32	2"	76	158,5	71,4		210	3000
Z33232	51	32	2"	32	2"	77	176,5	71,4		210	3000
Z34032	51	32	2"	40	2 1/2"	90	186,5	84,1		175	2500

ISO12151/3
SAE J516

SFL45

45° FLANGE ELBOW - ISO "L" SERIES - SAE CODE 61
FLENS BOCHT 45° - ISO SERIE "L" - SAE CODE 61

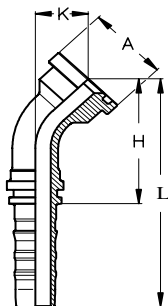

TIEFFE Part.N.	Hose I.D. Ø interno tubo			Flange Flangia		Dimensions (mm)				Maximum W.P.	
	DN	Size	Inch	Size	Inch	H	L	K	A	bar	PSI
Z3451212	20	12	3/4"	12	3/4"	63	114	25	38,1	350	5000
Z3451612	20	12	3/4"	16	1"	65	116	27	44,5	350	5000
Z3451216	25	16	1"	12	3/4"	81	137	31	38,1	350	5000
Z3451616	25	16	1"	16	1"	78	134	28	44,5	350	5000
Z3452016	25	16	1"	20	1 1/4"	78	134	28	50,8	280	4000
Z3451620	32	20	1 1/4"	16	1"	96	163	37	44,5	350	5000
Z3452020	32	20	1 1/4"	20	1 1/4"	91	157	32	50,8	280	4000
Z3452420	32	20	1 1/4"	24	1 1/2"	91	157	32	60,4	210	3000
Z3452424	38	24	1 1/2"	24	1 1/2"	108	191	36	60,4	210	3000
Z3453224	38	24	1 1/2"	32	2"	107	189	35	71,4	210	3000
Z3453232	51	32	2"	32	2"	151	245	57	71,4	210	3000
Z3454032	51	32	2"	40	2 1/2"	146	243	51	84,1	175	2500

ISO12151/3
SAE J516

SFL90

90° FLANGE ELBOW - ISO "L" SERIES - SAE CODE 61
FLENS BOCHT 90° - ISO SERIE "L" - SAE CODE 61

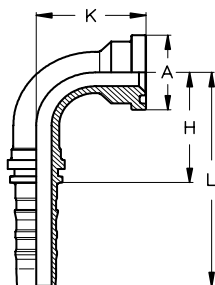

TIEFFE Part.N.	Hose I.D. Ø interno tubo			Flange Flangia		Dimensions (mm)				Maximum W.P.	
	DN	Size	Inch	Size	Inch	H	L	K	A	bar	PSI
Z3901212	20	12	3/4"	12	3/4"	55	106	51	38,1	350	5000
Z3901612	20	12	3/4"	16	1"	55	106	55	44,5	350	5000
Z3902012	20	12	3/4"	20	1 1/4"	55	106	60	50,8	280	4000
Z3901216	25	16	1"	12	3/4"	71	128	65	38,1	350	5000
Z3901616	25	16	1"	16	1"	71	128	61	44,5	350	5000
Z3902016	25	16	1"	20	1 1/4"	71	128	61	50,8	280	4000
Z3902416	25	16	1"	24	1 1/2"	71	128	61	60,4	210	3000
Z3901620	32	20	1 1/4"	16	1"	87	154	79	44,5	350	5000
Z3902020	32	20	1 1/4"	20	1 1/4"	87	154	71	50,8	280	4000
Z3902420	32	20	1 1/4"	24	1 1/2"	87	154	71	60,4	210	3000
Z3902424	38	24	1 1/2"	24	1 1/2"	105	188	83	60,4	210	3000
Z3903224	38	24	1 1/2"	32	2"	105	188	81	71,4	210	3000
Z3903232	51	32	2"	32	2"	140	237	122	71,4	210	3000
Z3904032	51	32	2"	40	2 1/2"	140	237	117	84,1	175	2500

**ISO12151/3
SAE J516**

SFL22,5

22,5° FLANGE ELBOW - ISO "L" SERIES - SAE CODE 61
FLENS BOCHT 22,5° - ISO SERIE "L" - SAE CODE 61

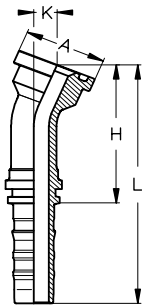

TIEFFE Part.N.	Hose I.D. Ø interno tubo			Flange Flangia		Dimensions (mm)					Maximum W.P.	
	DN	Size	Inch	Size	Inch	H	L	K	A		bar	PSI
Z32251212	20	12	3/4"	12	3/4"	70	121	11	38,1		350	5000
Z32251612	20	12	3/4"	16	1"	73	124	12	44,5		350	5000
Z32251616	25	16	1"	16	1"	86	142	12	44,5		350	5000
Z32252016	25	16	1"	20	1 1/4"	86	142	12	50,8		280	4000
Z32252020	32	20	1 1/4"	20	1 1/4"	100	166	13	50,8		280	4000
Z32252420	32	20	1 1/4"	24	1 1/2"	100	166	13	60,4		210	3000
Z32252424	38	24	1 1/2"	24	1 1/2"	118	201	15	60,4		210	3000
Z32253224	38	24	1 1/2"	32	2"	116	199	14	71,4		210	3000
Z32253232	51	32	2"	32	2"	165	262	22	71,4		210	3000

**ISO12151/3
SAE J516**

SFL30

30° FLANGE ELBOW - ISO "L" SERIES - SAE CODE 61
FLENS BOCHT 30° - ISO SERIE "L" - SAE CODE 61

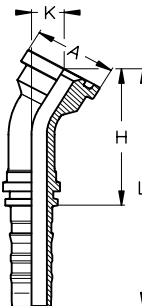

TIEFFE Part.N.	Hose I.D. Ø interno tubo			Flange Flangia		Dimensions (mm)					Maximum W.P.	
	DN	Size	Inch	Size	Inch	H	L	K	A		bar	PSI
Z3301212	20	12	3/4"	12	3/4"	68	119	16	38,1		350	5000
Z3301612	20	12	3/4"	16	1"	71	122	17	44,5		350	5000
Z3301616	25	16	1"	16	1"	84	140	17	44,5		350	5000
Z3302016	25	16	1"	20	1 1/4"	84	140	17	50,8		280	4000
Z3302020	32	20	1 1/4"	20	1 1/4"	98	164	19	50,8		280	4000
Z3302420	32	20	1 1/4"	24	1 1/2"	98	164	19	60,4		210	3000
Z3302424	38	24	1 1/2"	24	1 1/2"	116	199	22	60,4		210	3000
Z3303224	38	24	1 1/2"	32	2"	114	197	21	71,4		210	3000
Z3303232	51	32	2"	32	2"	162	258	31	71,4		210	3000

**ISO12151/3
SAE J516**

SFL60

60° FLANGE ELBOW - ISO "L" SERIES - SAE CODE 61
FLENS BOCHT 60° - ISO SERIE "L" - SAE CODE 61

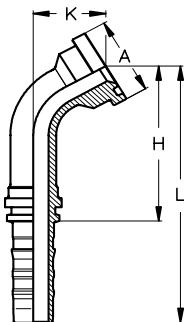

TIEFFE Part.N.	Hose I.D. Ø interno tubo			Flange Flangia		Dimensions (mm)					Maximum W.P.	
	DN	Size	Inch	Size	Inch	H	L	K	A		bar	PSI
Z3601212	20	12	3/4"	12	3/4"	77	128	34	38,1		350	5000
Z3601612	20	12	3/4"	16	1"	79	130	37	44,5		350	5000
Z3601616	25	16	1"	16	1"	98	154	40	44,5		350	5000
Z3602016	25	16	1"	20	1 1/4"	98	154	40	50,8		280	4000
Z3602020	32	20	1 1/4"	20	1 1/4"	118	184	45	50,8		280	4000
Z3602420	32	20	1 1/4"	24	1 1/2"	118	184	45	60,4		210	3000
Z3602424	38	24	1 1/2"	24	1 1/2"	140	223	52	60,4		210	3000
Z3603224	38	24	1 1/2"	32	2"	139	222	50	71,4		210	3000
Z3603232	51	32	2"	32	2"	192	289	73	71,4		210	3000

**ISO12151/3
SAE J516**

SFL67,5

67,5° FLANGE ELBOW - ISO "L" SERIES - SAE CODE 61
FLENS BOCHT 67,5° - ISO SERIE "L" - SAE CODE 61

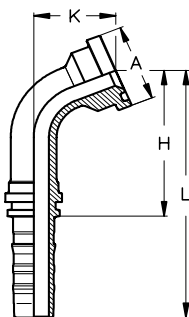

TIEFFE Part.N.	Hose I.D. Ø interno tubo			Flange Flangia		Dimensions (mm)					Maximum W.P.	
	DN	Size	Inch	Size	Inch	H	L	K	A		bar	PSI
Z36751212	20	12	3/4"	12	3/4"	72	123	39	38,1		350	5000
Z36751612	20	12	3/4"	16	1"	73	124	41	44,5		350	5000
Z36751616	25	16	1"	16	1"	92	148	45	44,5		350	5000
Z36752016	25	16	1"	20	1 1/4"	92	148	45	50,8		280	4000
Z36752020	32	20	1 1/4"	20	1 1/4"	111	178	52	50,8		280	4000
Z36752420	32	20	1 1/4"	24	1 1/2"	111	178	52	60,4		210	3000
Z36752424	38	24	1 1/2"	24	1 1/2"	133	216	60	60,4		210	3000
Z36753024	38	24	1 1/2"	32	2"	132	215	58	71,4		210	3000
Z36753232	51	32	2"	32	2"	181	278	84	71,4		210	3000

**ISO12151/3
SAE J516**

SFL100

100° FLANGE ELBOW - ISO "L" SERIES - SAE CODE 61
FLENS BOCHT 100° - ISO SERIE "L" - SAE CODE 61

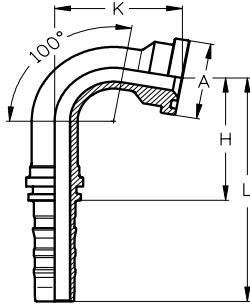

TIEFFE Part.N.	Hose I.D. Ø interno tubo			Flange Flangia		Dimensions (mm)				Maximum W.P.	
	DN	Size	Inch	Size	Inch	H	L	K	A	bar	PSI
Z31001212	20	12	3/4"	12	3/4"	61	112	59	38,1	350	5000
Z31001616	25	16	1"	16	1"	77	134	68	44,5	350	5000

**ISO12151/3
SAE J516**

SFL110

110° FLANGE ELBOW - ISO "L" SERIES - SAE CODE 61
FLENS BOCHT 110° - ISO SERIE "L" - SAE CODE 61

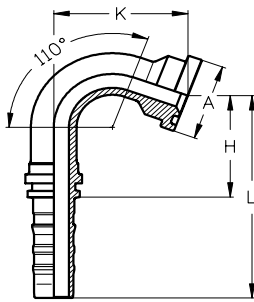

TIEFFE Part.N.	Hose I.D. Ø interno tubo			Flange Flangia		Dimensions (mm)				Maximum W.P.	
	DN	Size	Inch	Size	Inch	H	L	K	A	bar	PSI
Z31101212	20	12	3/4"	12	3/4"	51	102	62	38,1	350	5000
Z31101616	25	16	1"	16	1"	65	121	73	44,5	350	5000
Z31102016	25	16	1"	20	1 1/4"	65	121	73	50,8	280	4000
Z31102020	32	20	1 1/4"	20	1 1/4"	82	148	83	50,8	280	4000
Z31102420	32	20	1 1/4"	24	1 1/2"	82	148	83	60,4	210	3000
Z31102424	38	24	1 1/2"	24	1 1/2"	95	178	97	60,4	210	3000
Z31103232	51	32	2"	32	2"	124	220	142	71,4	210	3000

**ISO12151/3
SAE J516**

SFL135

135° FLANGE ELBOW - ISO "L" SERIES - SAE CODE 61
FLENS BOCHT 135° - ISO SERIE "L" - SAE CODE 61

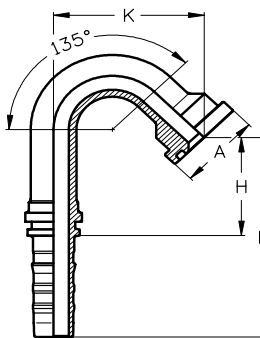

TIEFFE Part.N.	Hose I.D. Ø interno tubo			Flange Flangia		Dimensions (mm)				Maximum W.P.	
	DN	Size	Inch	Size	Inch	H	L	K	A	bar	PSI
Z31351212	20	12	3/4"	12	3/4"	69	120	70	38,1	350	5000
Z31351612	20	12	3/4"	16	1"	69	120	70	44,5	350	5000
Z31351616	25	16	1"	16	1"	57	113	86	44,5	350	5000

ISO12151/3
SAE J516

SFL90

90° LONG DROP FLANGE ELBOW - ISO "L" SERIES - SAE CODE 61
FLENS 90° LANGE BOCHT - ISO SERIE "L" - SAE CODE 61

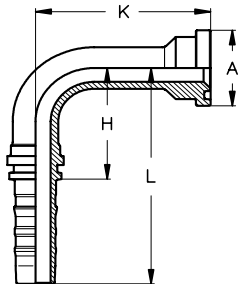

TIEFFE Part.N.	Hose I.D. Ø interno tubo			Flange Flangia		Dimensions (mm)					Maximum W.P.	
	DN	Size	Inch	Size	Inch	H	L	K	A	bar	PSI	
Z3901212-K96	20	12	3/4"	12	3/4"	55	106	96	38,1		350	5000
Z3901212-K127	20	12	3/4"	12	3/4"	55	106	127	38,1		350	5000
Z3901612-K79	20	12	3/4"	16	1"	55	106	79	44,5		350	5000
Z3901616-K118	25	16	1"	16	1"	71	128	118	44,5		350	5000
Z3902016-K118	25	16	1"	20	1 1/4"	71	128	118	50,8		280	4000
Z3902020-K91	32	20	1 1/4"	20	1 1/4"	87	154	91	50,8		280	4000
Z3902020-K102	32	20	1 1/4"	20	1 1/4"	87	154	102	50,8		280	4000
Z3902020-K112	32	20	1 1/4"	20	1 1/4"	87	154	112	50,8		280	4000
Z3902020-K130	32	20	1 1/4"	20	1 1/4"	87	154	130	50,8		280	4000
Z3902020-K168	32	20	1 1/4"	20	1 1/4"	87	154	168	50,8		280	4000
Z3902420-K118	32	20	1 1/4"	24	1 1/2"	87	154	118	60,4		210	3000
Z3902420-K130	32	20	1 1/4"	24	1 1/2"	87	154	130	60,4		210	3000
Z3902424-K148	38	24	1 1/2"	24	1 1/2"	105	188	148	60,4		210	3000
Z3902424-K172	38	24	1 1/2"	24	1 1/2"	105	188	172	60,4		210	3000
Z3903224-K115	38	24	1 1/2"	32	2"	105	188	115	71,4		210	3000
Z3903224-K172	38	24	1 1/2"	32	2"	105	188	172	71,4		210	3000
Z3903232-K165	51	32	2"	32	2"	140	237	165	71,4		210	3000
Z3903232-K203	51	32	2"	32	2"	140	237	203	71,4		210	3000

O'RING SEAL FOR ISO "L" SERIES - SAE CODE 61 FLANGES

ORING VOOR ISO SERIE "L" - SAE CODE 61



TIEFFE Part.N.	Flange Flangia		Dimensions (mm)	
	Size	Inch	ISO 3601-1	SAE
OR90SH35302499	12	3/4"	25x3,55	24,99x3,53
OR90SH35303292	16	1"	32,5x3,55	32,92x3,53
OR90SH35303769	20	1 1/4"	37,5x3,55	37,69x3,53
OR90SH35304722	24	1 1/2"	47,5x3,55	47,22x3,53
OR90SH35305674	32	2"	56x3,55	56,74x3,53

**ISO12151/3
SAE J516**

SFS **STRAIGHT FLANGE - ISO "S" SERIES - SAE CODE 62**
FLENS RECHT - ISO SERIE "S" - SAE CODE 62

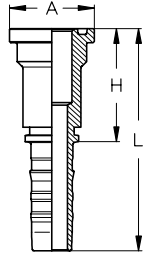

TIEFFE Part.N.	Hose I.D. Ø interno tubo			Flange Flangia		Dimensions (mm)					Maximum W.P.	
	DN	Size	Inch	Size	Inch	H	L	A			bar	PSI
Z61212	20	12	3/4"	12	3/4"	59	110	41,3			420	6000
Z61612	20	12	3/4"	16	1"	61	112	47,6			420	6000
Z61216	25	16	1"	12	3/4"	65	121,5	41,3			420	6000
Z61616	25	16	1"	16	1"	65	121,5	47,6			420	6000
Z62016	25	16	1"	20	1 1/4"	69	125,5	54			420	6000
Z61620	32	20	1 1/4"	16	1"	70	136,5	47,6			420	6000
Z62020	32	20	1 1/4"	20	1 1/4"	70	136,5	54			420	6000
Z62420	32	20	1 1/4"	24	1 1/2"	80	146,5	63,5			420	6000
Z62424	38	24	1 1/2"	24	1 1/2"	84	116,5	63,5			420	6000
Z63224	38	24	1 1/2"	32	2"	99	181,5	79,4			420	6000
Z63232	51	32	2"	32	2"	100	196,5	79,4			350	5000

**ISO12151/3
SAE J516**

SFS45 **45° FLANGE ELBOW - ISO "S" SERIES - SAE CODE 62**
FLENS 45° - ISO SERIE "S" - SAE CODE 62

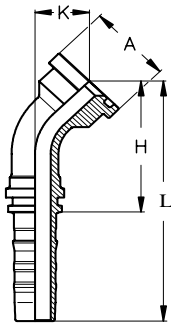

TIEFFE Part.N.	Hose I.D. Ø interno tubo			Flange Flangia		Dimensions (mm)					Maximum W.P.	
	DN	Size	Inch	Size	Inch	H	L	K	A		bar	PSI
Z6451212	20	12	3/4"	12	3/4"	66	117	28	41,3		420	6000
Z6451612	20	12	3/4"	16	1"	68	118	29	47,6		420	6000
Z6451216	25	16	1"	12	3/4"	81	137	31	41,3		420	6000
Z6451616	25	16	1"	16	1"	80	136	30	47,6		420	6000
Z6452016	25	16	1"	20	1 1/4"	80	136	30	54		420	6000
Z6451620	32	20	1 1/4"	16	1"	96	163	37	47,6		420	6000
Z6452020	32	20	1 1/4"	20	1 1/4"	93	160	34	54		420	6000
Z6452420	32	20	1 1/4"	24	1 1/2"	94	161	35	63,5		420	6000
Z6452424	38	24	1 1/2"	24	1 1/2"	112	195	40	63,5		420	6000
Z6453224	38	24	1 1/2"	32	2"	115	198	43	79,4		420	6000
Z6453232	51	32	2"	32	2"	150	247	56	79,4		350	5000

**ISO12151/3
SAE J516**

SFS90 **90° FLANGE ELBOW - ISO "S" SERIES - SAE CODE 62**
FLENS 90° - ISO SERIE "S" - SAE CODE 62

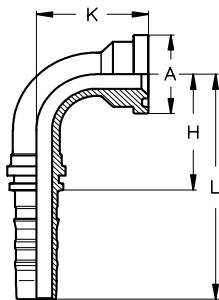

TIEFFE Part.N.	Hose I.D. Ø interno tubo			Flange Flangia		Dimensions (mm)					Maximum W.P.	
	DN	Size	Inch	Size	Inch	H	L	K	A		bar	PSI
Z6901212	20	12	3/4"	12	3/4"	55	106	56	41,3		420	6000
Z6901612	20	12	3/4"	16	1"	55	106	58	47,6		420	6000
Z6901216	25	16	1"	12	3/4"	71	128	65	41,3		420	6000
Z6901616	25	16	1"	16	1"	71	128	64	47,6		420	6000
Z6902016	25	16	1"	20	1 1/4"	71	128	64	54		420	6000
Z6901620	32	20	1 1/4"	16	1"	87	154	79	47,6		420	6000
Z6902020	32	20	1 1/4"	20	1 1/4"	87	154	74	54		420	6000
Z6902420	32	20	1 1/4"	24	1 1/2"	87	154	76	63,5		420	6000
Z6902424	38	24	1 1/2"	24	1 1/2"	105	188	88	63,5		420	6000
Z6903224	38	24	1 1/2"	32	2"	105	188	93	79,4		420	6000
Z6903232	51	32	2"	32	2"	140	237	123	79,4		350	5000

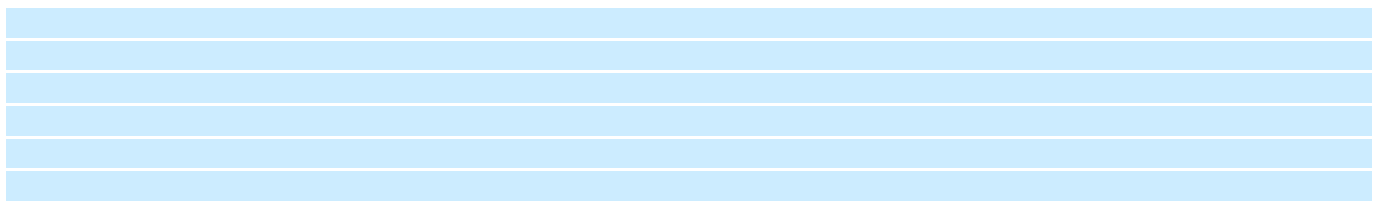

ISO12151/3
SAE J516

SFS22,5

22,5° FLANGE ELBOW - ISO "S" SERIES - SAE CODE 62
FLENS 22,5° - ISO SERIE "S" - SAE CODE 62

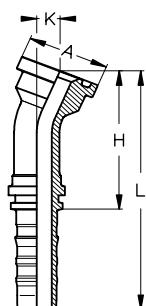

TIEFFE Part.N.	Hose I.D. Ø interno tubo			Flange Flangia		Dimensions (mm)				Maximum W.P.	
	DN	Size	Inch	Size	Inch	H	L	K	A	bar	PSI
	20	12	3/4"	12	3/4"	74	125	13	41,3	420	6000
	20	12	3/4"	16	1"	76	127	14	47,6	420	6000
	25	16	1"	16	1"	89	145	13	47,6	420	6000
	25	16	1"	20	1 1/4"	89	145	13	54	420	6000
	32	20	1 1/4"	20	1 1/4"	103	169	15	54	420	6000
	32	20	1 1/4"	24	1 1/2"	104	171	15	63,5	420	6000
	38	24	1 1/2"	24	1 1/2"	123	206	17	63,5	420	6000
	38	24	1 1/2"	32	2"	127	210	19	79,4	420	6000
	51	32	2"	32	2"	166	263	24	79,4	350	5000

ISO12151/3
SAE J516

SFS30

30° FLANGE ELBOW - ISO "S" SERIES - SAE CODE 62
FLENS 30° - ISO SERIE "S" - SAE CODE 62

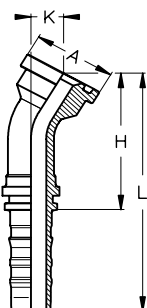

TIEFFE Part.N.	Hose I.D. Ø interno tubo			Flange Flangia		Dimensions (mm)				Maximum W.P.	
	DN	Size	Inch	Size	Inch	H	L	K	A	bar	PSI
	20	12	3/4"	12	3/4"	72	123	18	41,3	420	6000
	20	12	3/4"	16	1"	74	125	19	47,6	420	6000
	25	16	1"	16	1"	87	143	19	47,6	420	6000
	25	16	1"	20	1 1/4"	87	143	19	54	420	6000
	32	20	1 1/4"	20	1 1/4"	100	167	20	54	420	6000
	32	20	1 1/4"	24	1 1/2"	102	168	21	63,5	420	6000
	38	24	1 1/2"	24	1 1/2"	121	203	24	63,5	420	6000
	38	24	1 1/2"	32	2"	124	207	26	79,4	420	6000
	51	32	2"	32	2"	162	259	34	79,4	350	5000

ISO12151/3
SAE J516

SFS60

60° FLANGE ELBOW - ISO "S" SERIES - SAE CODE 62
FLENS 60° - ISO SERIE "S" - SAE CODE 62

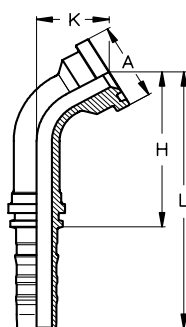

TIEFFE Part.N.	Hose I.D. Ø interno tubo			Flange Flangia		Dimensions (mm)				Maximum W.P.	
	DN	Size	Inch	Size	Inch	H	L	K	A	bar	PSI
Z6601212	20	12	3/4"	12	3/4"	79	130	38	41,3	420	6000
Z6601612	20	12	3/4"	16	1"	80	131	40	47,6	420	6000
Z6601616	25	16	1"	16	1"	99	155	42	47,6	420	6000
Z6602016	25	16	1"	20	1 1/4"	99	155	42	54	420	6000
Z6602020	32	20	1 1/4"	20	1 1/4"	119	185	47	54	420	6000
Z6602420	32	20	1 1/4"	24	1 1/2"	120	186	49	63,5	420	6000
Z6602424	38	24	1 1/2"	24	1 1/2"	143	225	56	63,5	420	6000
Z6603224	38	24	1 1/2"	32	2"	145	228	60	79,4	420	6000
Z6603232	51	32	2"	32	2"	193	289	79	79,4	350	5000

ISO12151/3
SAE J516

SFS67,5

67,5° FLANGE ELBOW - ISO "S" SERIES - SAE CODE 62
FLENS 67,5° - ISO SERIE "S" - SAE CODE 62

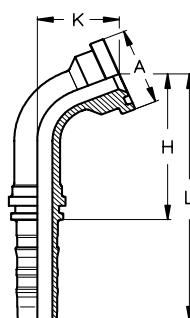

TIEFFE Part.N.	Hose I.D. Ø interno tubo			Flange Flangia		Dimensions (mm)				Maximum W.P.	
	DN	Size	Inch	Size	Inch	H	L	K	A	bar	PSI
	20	12	3/4"	12	3/4"	74	125	43	41,3	420	6000
	20	12	3/4"	16	1"	75	126	45	47,6	420	6000
	25	16	1"	16	1"	93	150	48	47,6	420	6000
	25	16	1"	20	1 1/4"	93	150	48	54	420	6000
	32	20	1 1/4"	20	1 1/4"	112	179	54	54	420	6000
	32	20	1 1/4"	24	1 1/2"	113	180	56	63,5	420	6000
	38	24	1 1/2"	24	1 1/2"	135	217	65	63,5	420	6000
	38	24	1 1/2"	32	2"	137	219	69	79,4	420	6000
	51	32	2"	32	2"	182	278	90	79,4	350	5000

SFS^{UPERCAT}

"SUPERCAT" STRAIGHT FLANGE FLENS "SUPERCAT" - RECHT

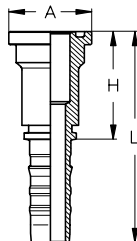

TIEFFE Part.N.	Hose I.D. Ø interno tubo			Flange Flangia		Dimensions (mm)					Maximum W.P.	
	DN	Size	Inch	Size	Inch	H	L	A		D'RING	bar	PSI
ZC1212	20	12	3/4"	12	3/4"	84	135	41,3		DR12	420	6000
ZC1612	20	12	3/4"	16	1"	84	135	47,6		DR16	420	6000
ZC1616	25	16	1"	16	1"	90	146,5	47,6		DR16	420	6000
ZC2016	25	16	1"	20	1 1/4"	90	146,5	54		DR20	420	6000
ZC2020	32	20	1 1/4"	20	1 1/4"	88	154,4	54		DR20	420	6000
ZC2420	32	20	1 1/4"	24	1 1/2"	88	154,5	63,5		DR24	420	6000
ZC2424	38	24	1 1/2"	24	1 1/2"	84	166,5	63,5		DR24	420	6000
ZC3224	38	24	1 1/2"	32	2"	110	192,5	79,4		DR32	420	6000
ZC3232	51	32	2"	32	2"	130	226,5	79,4		DR32	350	5000

SFS^{UPERCAT45}

"SUPERCAT" 45° FLANGE ELBOW FLENS "SUPERCAT" - BOCHT 45°

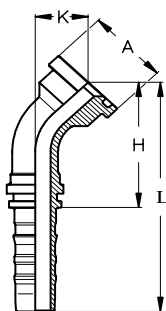

TIEFFE Part.N.	Hose I.D. Ø interno tubo			Flange Flangia		Dimensions (mm)					Maximum W.P.	
	DN	Size	Inch	Size	Inch	H	L	K	A	D'RING	bar	PSI
ZC451212	20	12	3/4"	12	3/4"	72	123	34	41,3	DR12	420	6000
ZC451612	20	12	3/4"	16	1"	74	125	36	47,6	DR16	420	6000
ZC451616	25	16	1"	16	1"	86	143	36	47,6	DR16	420	6000
ZC452016	25	16	1"	20	1 1/4"	86	143	36	54	DR20	420	6000
ZC452020	32	20	1 1/4"	20	1 1/4"	96	162	36	54	DR20	420	6000
ZC452420	32	20	1 1/4"	24	1 1/2"	96	162	36	63,5	DR24	420	6000
ZC452424	38	24	1 1/2"	24	1 1/2"	114	196	41	63,5	DR24	420	6000
ZC453224	38	24	1 1/2"	32	2"	116	199	44	79,4	DR32	420	6000
ZC453232	51	32	2"	32	2"	152	250	57	79,4	DR32	350	5000

SFS^{UPERCAT90}

"SUPERCAT" 90° FLANGE ELBOW FLENS "SUPERCAT" - BOCHT 90°

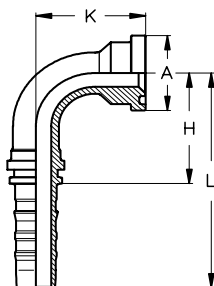

TIEFFE Part.N.	Hose I.D. Ø interno tubo			Flange Flangia		Dimensions (mm)					Maximum W.P.	
	DN	Size	Inch	Size	Inch	H	L	K	A	D'RING	bar	PSI
ZC901212	20	12	3/4"	12	3/4"	55	106	64	41,3	DR12	420	6000
ZC901612	20	12	3/4"	16	1"	55	106	64	47,6	DR16	420	6000
ZC901616	25	16	1"	16	1"	71	128	73	47,6	DR16	420	6000
ZC902016	25	16	1"	20	1 1/4"	71	128	73	54	DR20	420	6000
ZC902020	32	20	1 1/4"	20	1 1/4"	87	154	77	54	DR20	420	6000
ZC902420	32	20	1 1/4"	24	1 1/2"	87	154	78	63,5	DR24	420	6000
ZC902424	38	24	1 1/2"	24	1 1/2"	105	188	90	63,5	DR24	420	6000
ZC903224	38	24	1 1/2"	32	2"	105	188	94	79,4	DR32	420	6000
ZC903232	51	32	2"	32	2"	140	237	125	79,4	DR32	350	5000

SFS^{SUPERCAT}22,5

"SUPERCAT" 22,5° FLANGE ELBOW FLENS "SUPERCAT" - BOCHT 22,5°

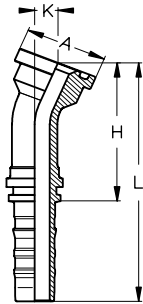

TIEFFE Part.N.	Hose I.D. Ø interno tubo			Flange Flangia		Dimensions (mm)					Maximum W.P.	
	DN	Size	Inch	Size	Inch	H	L	K	A	D'RING	bar	PSI
	20	12	3/4"	12	3/4"	82	133	16	41,3	DR12	420	6000
	20	12	3/4"	16	1"	84	135	17	47,6	DR16	420	6000
	25	16	1"	16	1"	97	153	17	47,6	DR16	420	6000
	25	16	1"	20	1 1/4"	97	153	17	54	DR20	420	6000
	32	20	1 1/4"	20	1 1/4"	406	172	16	54	DR20	420	6000
	32	20	1 1/4"	24	1 1/2"	406	174	16	63,5	DR24	420	6000
	38	24	1 1/2"	24	1 1/2"	125	208	18	63,5	DR24	420	6000
	38	24	1 1/2"	32	2"	129	211	19	79,4	DR32	420	6000
	51	32	2"	32	2"	168	265	25	79,4	DR32	350	5000

SFS^{SUPERCAT}30

"SUPERCAT" 30° FLANGE ELBOW FLENS "SUPERCAT" - BOCHT 30°

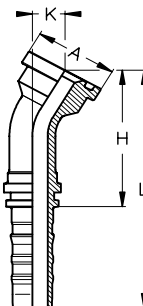

TIEFFE Part.N.	Hose I.D. Ø interno tubo			Flange Flangia		Dimensions (mm)					Maximum W.P.	
	DN	Size	Inch	Size	Inch	H	L	K	A	D'RING	bar	PSI
	20	12	3/4"	12	3/4"	79	130	22	41,3	DR12	420	6000
	20	12	3/4"	16	1"	82	133	23	47,6	DR16	420	6000
	25	16	1"	16	1"	94	151	23	47,6	DR16	420	6000
	25	16	1"	20	1 1/4"	94	151	23	54	DR20	420	6000
	32	20	1 1/4"	20	1 1/4"	103	170	22	54	DR20	420	6000
	32	20	1 1/4"	24	1 1/2"	104	170	23	63,5	DR24	420	6000
	38	24	1 1/2"	24	1 1/2"	123	205	25	63,5	DR24	420	6000
	38	24	1 1/2"	32	2"	126	208	27	79,4	DR32	420	6000
	51	32	2"	32	2"	164	264	35	79,4	DR32	350	5000

SFS^{SUPERCAT}60

"SUPERCAT" 60° FLANGE ELBOW FLENS "SUPERCAT" - BOCHT 60°

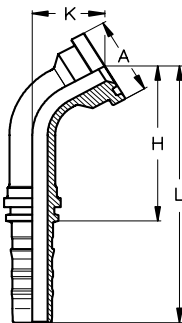

TIEFFE Part.N.	Hose I.D. Ø interno tubo			Flange Flangia		Dimensions (mm)					Maximum W.P.	
	DN	Size	Inch	Size	Inch	H	L	K	A	D'RING	bar	PSI
	20	12	3/4"	12	3/4"	83	134	45	41,3	DR12	420	6000
	20	12	3/4"	16	1"	85	136	48	47,6	DR16	420	6000
	25	16	1"	16	1"	103	160	50	47,6	DR16	420	6000
	25	16	1"	20	1 1/4"	103	160	50	54	DR20	420	6000
	32	20	1 1/4"	20	1 1/4"	121	187	50	54	DR20	420	6000
	32	20	1 1/4"	24	1 1/2"	121	187	51	63,5	DR24	420	6000
	38	24	1 1/2"	24	1 1/2"	144	226	58	63,5	DR24	420	6000
	38	24	1 1/2"	32	2"	146	228	61	79,4	DR32	420	6000
	51	32	2"	32	2"	194	290	81	79,4	DR32	350	5000

SFS^{SUPERCAT}67,5

"SUPERCAT" 67,5° FLANGE ELBOW FLENS "SUPERCAT" - BOCHT 67,5°

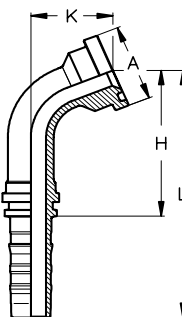

TIEFFE Part.N.	Hose I.D. Ø interno tubo			Flange Flangia		Dimensions (mm)					Maximum W.P.	
	DN	Size	Inch	Size	Inch	H	L	K	A	D'RING	bar	PSI
	20	12	3/4"	12	3/4"	77	128	50	41,3	DR12	420	6000
	20	12	3/4"	16	1"	79	130	53	47,6	DR16	420	6000
	25	16	1"	16	1"	97	153	56	47,6	DR16	420	6000
	25	16	1"	20	1 1/4"	97	153	56	54	DR20	420	6000
	32	20	1 1/4"	20	1 1/4"	114	181	57	54	DR20	420	6000
	32	20	1 1/4"	24	1 1/2"	114	181	58	63,5	DR24	420	6000
	38	24	1 1/2"	24	1 1/2"	137	219	66	63,5	DR24	420	6000
	38	24	1 1/2"	32	2"	138	220	69	79,4	DR32	420	6000
	51	32	2"	32	2"	184	280	92	79,4	DR32	350	5000

SFSUPERCAT 90

"SUPERCAT" 90° LONG DROP FLANGE ELBOW

FLANGIA "SUPERCAT" - CURVA 90° - INGOMBRO SPECIALE

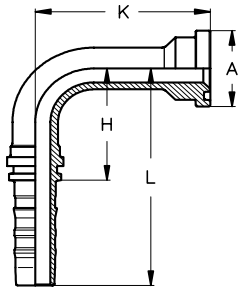

TIEFFE Part.N.	Hose I.D. Ø interno tubo			Flange Flangia		Dimensions (mm)					Maximum W.P.	
	DN	Size	Inch	Size	Inch	H	L	K	A	D'RING	bar	PSI
	20	12	3/4"	12	3/4"	55	106	129	41,3	DR12	420	6000
	25	16	1"	16	1"	71	128	132	47,6	DR16	420	6000
	25	16	1"	16	1"	71	128	150	47,6	DR16	420	6000
	32	20	1 1/4"	20	1 1/4"	87	154	150	54	DR20	420	6000
	32	20	1 1/4"	24	1 1/2"	87	154	135	63,5	DR24	420	6000
	38	24	1 1/2"	24	1 1/2"	105	188	106	63,5	DR24	420	6000

D'RING SEAL FOR "SUPERCAT" FLANGES

GUARNIZIONI D'RING PER FLANGE "SUPERCAT"

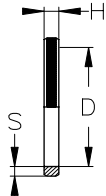

TIEFFE Part.N.	Flange Flangia		Dimensions (mm)		
	Size	Inch	D	H	S
DR12	12	3/4"	25,4	5	3,5
DR16	16	1"	31,8	5	3,5
DR20	20	1 1/4"	38,1	5	3,5
DR24	24	1 1/2"	44,5	5	3,5
DR32	32	2"	63,9	5	3,5



FEMALE SWIVEL ENDS TORQUE VALUES

SWIVEL END THREAD FILETTO FEMMINA GIREVOLE		TIEFFE DASH SIZE		NUT EXAGON ESAGONO DADO		TORQUE VALUE (Nm) COPPIA DI SERRAGGIO (Nm)	
				mm		Nominal	Min. - Max.
BSPP (GAS)	3/4"-14	12	FGO	32		115	95-135
BSPP (GAS)	1"-11	16	FGO	41		140	115-165
BSPP (GAS)	1 1/4"-11	20	FGO	50		210	140-280
BSPP (GAS)	1 1/2"-11	24	FGO	60		290	215-365
BSPP (GAS)	2"-11	32	FGO	75		400	300-500
J.I.C.	7/8"-14	10	FIC-FIS	27		69	44-94
J.I.C.	1 1/16"-12	12	FIC-FIS	32		98	63-133
J.I.C.	1 3/16"-12	14	FIC-FIS	36		118	73-163
J.I.C.	1 5/16"-12	16	FIC-FIS	41		140	90-190
J.I.C.	1 5/8"-12	20	FIC-FIS	50		210	135-285
J.I.C.	1 7/8"-12	24	FIC-FIS	60		290	215-365
J.I.C.	2 1/2"-12	32	FIC-FIS	75		400	300-500
ORFS	1 3/16"-12	12	FRC-FRS	36		90	95 max
ORFS	1 7/16"-12	16	FRC-FRS	41		125	135 max
ORFS	1 11/16"-12	20	FRC-FRS	50		170	190 max
ORFS	2"-12	24	FRC-FRS	60		200	225 max
METRIC	30x2	20S	FOS	36		135	115-155
METRIC	36x2	25S	FOS	46		166	140-192
METRIC	42x2	30S	FOS	50		240	210-270
METRIC	52x2	38S	FOS	60		330	280-380

**HOSE ASSEMBLING PROCEDURE - BY CHECKING INSERT
BORE COLLAPSE**

- 1- Select the specified hose (A), ferrules (B) and inserts (C) listed in the latest release of TIEFFE hose connectors catalogue. (See Figure 1)

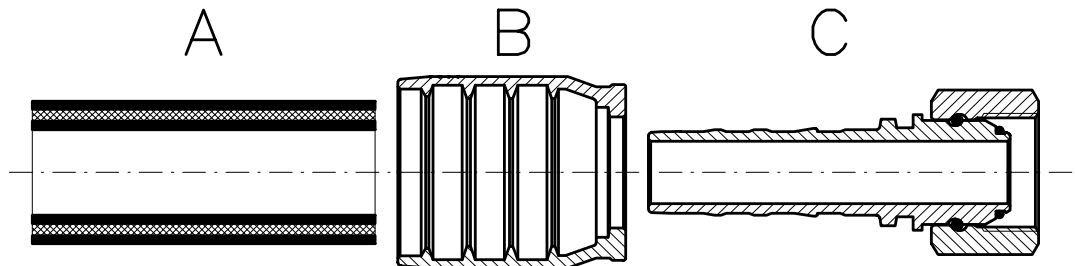

Figure 1

- 2- Cut the hose squarely using a rotary steel blade (non abrasive) to the required length.
- 3- **If skiving is required**, remove all rubber cover to the "skiving length" specified in the ASSEMBLING DATA TABLE avoiding damages to the steel wires reinforcement.
- 4- Place the ferrule fully onto the hose. Push the insert fully into the hose. Select the "COLLAPSE CONTROL MANDREL" for size and series of TIEFFE inserts. Insert the MANDREL into the insert bore. The "NO GO" part of the MANDREL must fully go into the insert bore. (See Figure 2). Remove the MANDREL.

**PROCEDURE VOOR MONTAGE SLANG COPPELING -
METHODE VOOR CONTROLE VAN DE COLLAPSE**

- 1- Selecteer de slang. (A), de huls (B) en de koppeling (C) Opgenomen in de laatste catalogus van KW Flextubo (zie figuur 1)

Figura 1

- 2- Zaag de slang met een metaal blad (non abrasieve) tot de gewenste lengte
- 3- **Als schillen nodig is, verwijder alle rubber tot** de "skiving length" gespecificeerd op de ASSEMBLING DATA TABLE maar voorkom beschadiging aan de stalen draden.
- 4- Schuif de huls om de slang Druk de koppeling in de slang Kies de Collapse (colpin) voor de maat van de Tieffe koppeling Druk de colpin in de slang Het dunne gedeelte van de colpin moet volledig in de koppeling gaan (kijk naar figuur 2) Verwijder de colpin

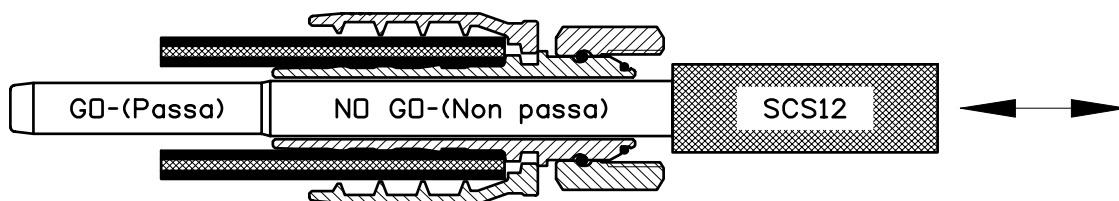

Figure 2

Figura 2

- 5- Crimp the ferrule to the diameter specified in the table ASSEMBLING DATA TABLE.
- 6- Inspect the crimp diameter by measuring it on each each die impressions. All measurements must be taken in in the center of ferrule length. All measurements must be according to the specified crimp diameters, within a tolerance +0,0/-0,2 mm.
- 7- Insert the "COLLAPSE CONTROL MANDREL".

- 5- Pers de huls tot de diameter gespecificeerd in de Montage tabel
- 6- Controleer de krimp diameter door te meten in elke koppeling. De maten moeten genomen in het midden van de huls. Alle maten moeten overeenkomen met de krimp diameter met een tolerantie van +0 tot -/ 0,2 mm
- 7- Controleer met de colpin

8- If the "NO GO" part of the MANDREL stops in the bore as shown in Figure 3, crimp diameter and bore collapse are correct.

9- If the "NO GO" part of the MANDREL goes through the bore, the crimp diameter must be reduced by increments of 0,1 mm to reach the condition shown in Figure 3.

10- If the "GO" part of the MANDREL does not go through the bore, the crimp diameter must be increased (step by step) to reach the condition shown in Figure 3.

8- Als het NO GO gedeelte van de colpin stopt in de boring zoals afgebeeld in figuur 3 crimp Diameter is correct

9 Als het NO Go gedeelte van de colpin er volledig ingaat , dan moet je verder persen met 0,1 mm elke keer, zie figuur 3

10 Als het Go gedeelte van de colpin er niet ingaat, dan moet de Crimp Diameter groter gemaakt worden stapje voor stapje totdat hij er weer inschuift. zie figuur 3

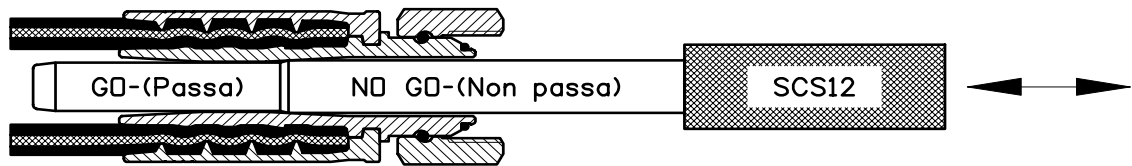

Figure 3

Figura 3

"SCS" COLLAPSE CONTROL MANDREL dimensions

Dimensies Colpin "SCS"

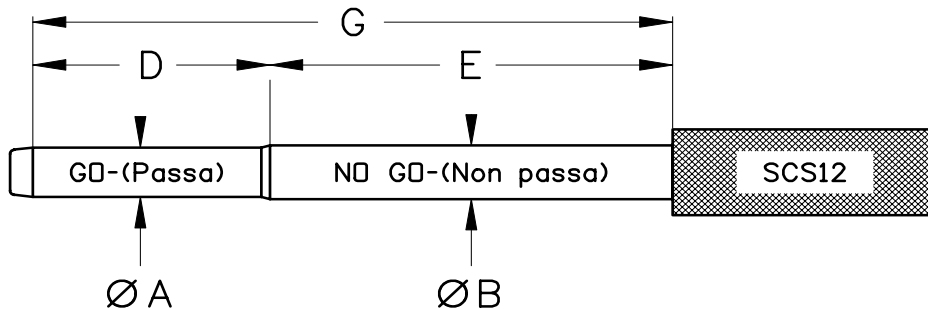
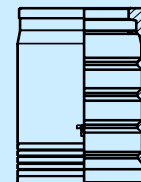
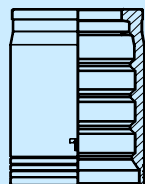

Figure 4

TIEFFE Part.N.	Hose I.D. Ø interno tubo			INSERT BORE COLLAPSE Collasso foro inserto (mm)		COLLAPSE CONTROL MANDREL dimensions (mm) Dimensioni SPINE DI CONTROLLO COLLASSO (mm)				
	DN	Size	Inch	minimum	maximum	ØA +0,00/-0,05	ØB +0,00/-0,05	D	E	G
SCS12	20	12	3/4"	0,70	1,40	12,60	13,30	55	115	170
SCS16	25	16	1"	0,80	1,60	17,4	18,2	60	130	190
SCS20	32	20	1 1/4"	0,90	1,80	22,7	23,6	70	150	220
SCS24	40	24	1 1/2"	1,00	2,00	28	29	85	185	270
SCS32	50	32	2"	1,20	2,40	37,6	38,8	100	230	330

SKIVE



BSS4

BSS6

SKIVE

Hose I.D. Ø Interno tubo			EN8564 SP			EN456 4SH			EN856 R12 SAE100 R12			EN856 R13 SAE100 R13			SAE100 R15			Collapse control mandrel Spina controllo collasso
			Ferrule Boccola	Skiving length Lung. di spellat.	Swaged diam. Diametro di press. (Ref.)	Ferrule Boccola	Skiving length Lung. di spellat.	Swaged diam. Diametro di press. (Ref.)	Ferrule Boccola	Skiving length Lung. di spellat.	Swaged diam. Diametro di press. (Ref.)	Ferrule Boccola	Skiving length Lung. di spellat.	Swaged diam. Diametro di press. (Ref.)	Ferrule Boccola	Skiving length Lung. di spellat.	Swaged diam. Diametro di press. (Ref.)	
DN	SIZE	Inch	Part. N.	mm	mm	Part. N.	mm	mm	Part. N.	mm	mm	Part. N.	mm	mm	Part. N.	mm	mm	Part. N.
19	12	3/4"	HSS412	41,5	32,5	HSS412	41,5	32,7	HSS412	41,5	32,1	HSS412	41,5	33,2	HSS412	41,5	33,2	SCS12
25	16	1"	HSS416	44,5	40,4	HSS416	44,5	40,3	HSS416	44,5	40,1	HSS416	44,5	40,8	HSS416	44,5	40,8	SCS16
31	20	1 1/4"	HSS620	53	50,7	HSS420	52,5	46,4	HSS420	52,5	48,0	HSS620	53	51,3	HSS620	53	51,3	SCS20
38	24	1 1/2"	HSS624	69	59,4	HSS424	68,5	57,4	HSS424	68,5	56,0	HSS624	69	60,8	HSS624	69	60,8	SCS24
51	32	2"	HSS632	78	73,6	HSS432	78	68,8	HSS432	78	69,1	HSS632	78	75,7				SCS32

**NON
SKIVE**

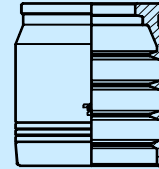

NON SKIVE

BSN4

Hose I.D. Ø Interno tubo			EN8564 SP			EN456 4SH			EN856 R12 SAE100 R12			EN856 R13 SAE100 R13			SAE100 R15			Collapse control mandrel Spina controllo collasso
			Ferrule Boccola		Swaged diam. Diametro di press. (Ref.)	Ferrule Boccola		Swaged diam. Diametro di press. (Ref.)	Ferrule Boccola		Swaged diam. Diametro di press. (Ref.)	Ferrule Boccola		Swaged diam. Diametro di press. (Ref.)	Ferrule Boccola		Swaged diam. Diametro di press. (Ref.)	
DN	SIZE	Inch	Part. N.		mm	Part. N.		mm	Part. N.		mm	Part. N.		mm	Part. N.		mm	Part. N.
19	12	3/4"	HSN412		35,9	HSN412		35,9	HSN412		34,6	HSN412		35,8	HSN412		35,8	SCS12
25	16	1"	HSN416		43,0	HSN416		42,1	HSN416		41,5	HSN416		42,2	HSN416		42,1	SCS16
31	20	1 1/4"				HSN420		50,6	HSN420		51,9							SCS20
38	24	1 1/2"				HSN424		60,0	HSN424		60,0							SCS24
51	32	2"				HSN432		73,8	HSN432		72,5							SCS32